

3-JAW CONCENTRIC GRIPPERS

SERIES OVERVIEW

1

3-Jaw Concentric Grippers / Electrical / Grippers



3-JAW CONCENTRIC GRIPPERS ELECTRICAL

▶ **FURTHER INFORMATION** on page 288

Series GED1300	WORKING CONDITIONS		FUNCTIONALITY				PRICE	
	clean	dirty	-	+	+	++		
	<input type="checkbox"/>	<input type="checkbox"/>	<input type="checkbox"/>	<input type="checkbox"/>	<input type="checkbox"/>	<input type="checkbox"/>	<input type="checkbox"/>	<input type="checkbox"/>

„The robust“

- ▶ Proven T slot guide
- ▶ Integrated position sensing
- ▶ The simplest activation

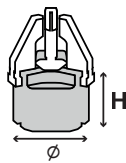

▶ **Technical Data**

Installation size	Stroke per Jaw [mm]		Gripping force [N]		Weight [kg]	
	from	to	from	to	from	to
GED1302	2	2	140	140	0,25	0,25
GED1306	6	6	350	350	1,7	1,7

▶ **Dimension**

Installation size	Ø [mm]	Height [mm]
GED1302	32	72
GED1306	85	110

▶ **FURTHER INFORMATION** on page 292

Series GED1500	WORKING CONDITIONS		FUNCTIONALITY				PRICE	
	clean	dirty	-	+	+	++		
	<input type="checkbox"/>	<input type="checkbox"/>	<input type="checkbox"/>	<input type="checkbox"/>	<input type="checkbox"/>	<input type="checkbox"/>	<input type="checkbox"/>	<input type="checkbox"/>

„The sealed“

- ▶ Sealed circular guide
- ▶ Integrated position sensing
- ▶ The simplest activation

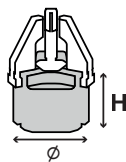

▶ **Technical Data**

Installation size	Stroke per Jaw [mm]		Gripping force [N]		Weight [kg]	
	from	to	from	to	from	to
GED1502	2	2	115	115	0,32	0,32
GED1506	6	6	290	290	2	2

▶ **Dimension**

Installation size	Ø [mm]	Height [mm]
GED1502	60	85
GED1506	101	121

3-JAW CONCENTRIC GRIPPERS

SERIES GED1300

▶ PRODUCT ADVANTAGES

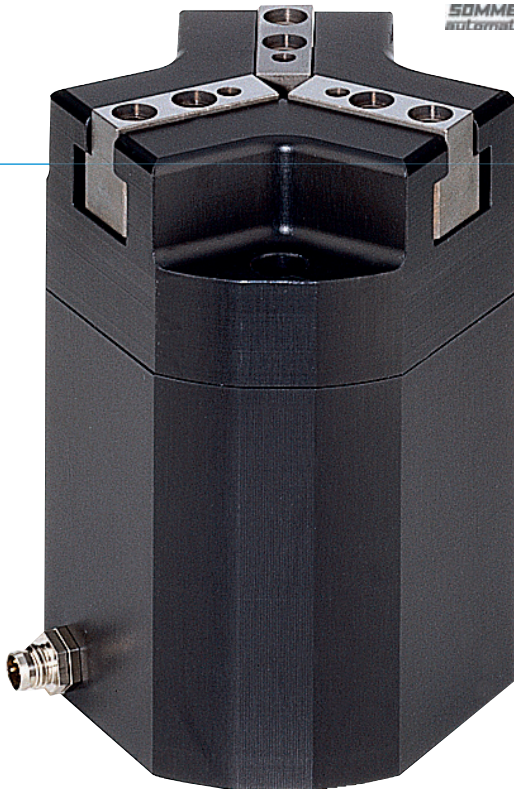

“The robust”

- ▶ **Proven T slot guide**
This established and proven guiding technology stands for the highest process reliability like no other
- ▶ **Integrated position sensing**
You can detect the gripper status safely via the motor current using your control system
- ▶ **The simplest activation**
The included control unit is controlled easily via plus and minus buttons, while you can optionally adjust the gripping force using the potentiometer

▶ THE BEST PRODUCT FOR YOUR APPLICATION



- ▶ **Our products love the challenge!**
Extreme conditions, all over the world—our tried and tested components and systems give you limitless possibilities:
Find the best product for your specific use:
www.zimmer-group.de

► BENEFITS IN DETAIL

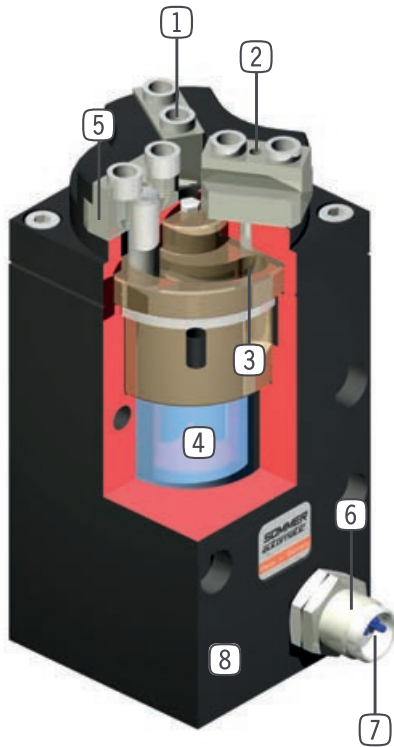

- ① **Removable centering sleeves**
 - quick and economical positioning of the gripper fingers
- ② **Gripper jaw**
 - hardened steel
 - individual gripper finger mounting
- ③ **Positively driven curve disc**
 - synchronized the movement of the gripper jaws
 - high force transfer
 - rapid stroke and force stroke (version with 6 mm stroke per jaw)
- ④ **Drive**
 - electric drive by 24 VDC step motor
- ⑤ **Guide**
 - precise T-Slot guide for high forces and moments capacity
- ⑥ **Position sensing**
 - measured at the end of stroke via power increase on the motor
- ⑦ **Energy supply**
 - standardized interface M8 round plug connection signal control line (use only cable without diode)
- ⑧ **Robust, lightweight housing**
 - hard coated aluminium alloy

► FURTHER INFORMATION IS AVAILABLE ONLINE



► Technical Information

All information just a click away at: www.zimmer-group.de

Find data, illustrations, 3D models and Installation instructions for your installation size using the order number for your desired product.

Quick, clear and always current.



3-JAW CONCENTRIC GRIPPERS

SERIES GED1300

1

Series GED1300 / 3-Jaw Concentric Grippers / electric / Grippers

Installation Size: GED1302

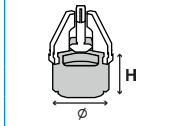

Dimension	
Ø [mm]	Height [mm]
32	72

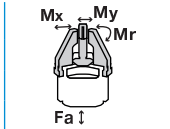

Force and moment			
Mr [Nm]	Mx [Nm]	My [Nm]	Fa [N]
5	5	4	120

Technical Data				
Stroke per jaw [mm]	Gripping force [N]		Weight [kg]	
	closing	opening		
GED1302	2	140	140	0.25

Installation Size: GED1306

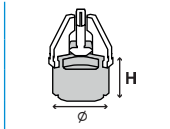

Dimension	
Ø [mm]	Height [mm]
85	110

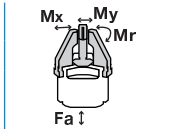

Force and moment			
Mr [Nm]	Mx [Nm]	My [Nm]	Fa [N]
30	25	20	800

Technical Data			
Stroke per jaw [mm]	Gripping force [N]		Weight [kg]
	closing	opening	
GED1306C	6	350	1.7
GED1306O	6	350	1.7

Gripping force diagram

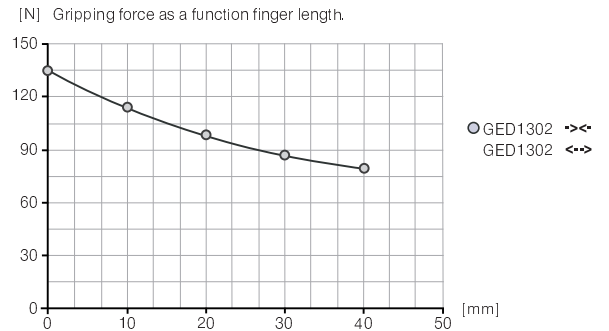

Gripping force diagram

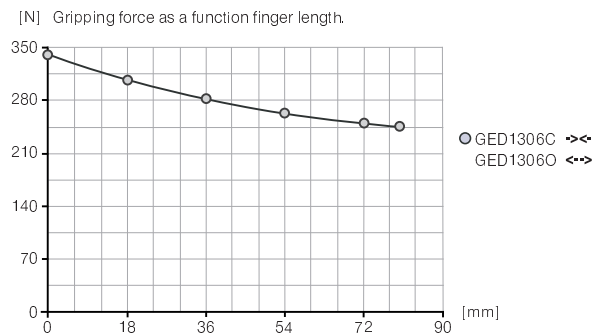

3-JAW CONCENTRIC GRIPPERS

SERIES GED1300

▶ ACCESSORIES

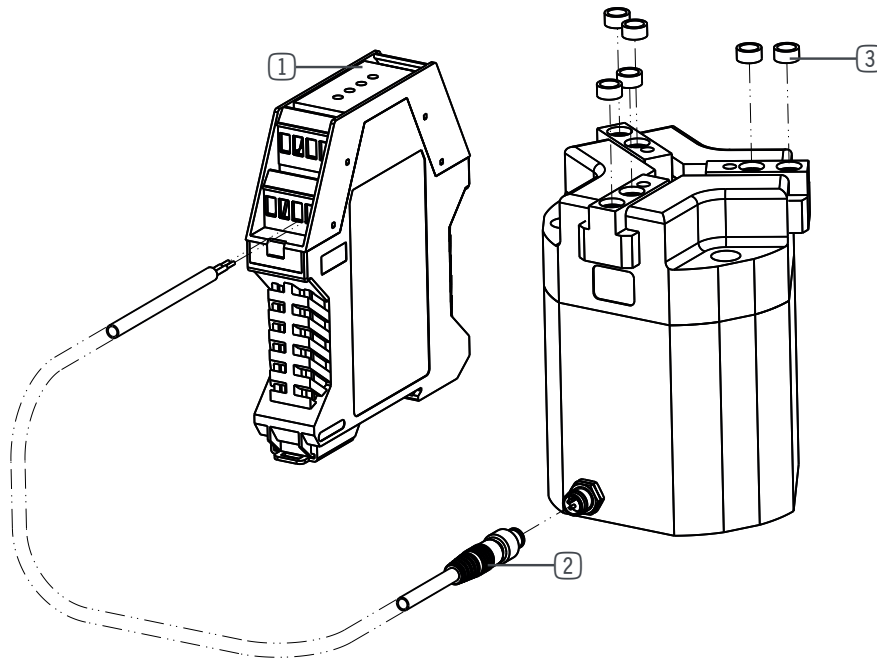

▶ Installation Size: GED1302

Pos.	Accessories	Order no.
②	Plug-in connector Straight Cable 5m - Socket M8 (female)	KAG500
②	Plug-in connector Angled Cable 5m - Socket M8 (female)	KAW500
Delivery contents		Order no.
①	Control	ELEGR01
③	Centering Disc	BDST02900

▶ Installation Size: GED1306

Pos.	Accessories	Order no.
②	Plug-in connector Straight Cable 5m - Socket M8 (female)	KAG500
②	Plug-in connector Angled Cable 5m - Socket M8 (female)	KAW500
Delivery contents		Order no.
①	Control	ELEGR04
③	Centering Disc	BDST40800

3-JAW CONCENTRIC GRIPPERS

SERIES GED1500

▶ PRODUCT ADVANTAGES



“The airtight”

▶ IP67

The sealed circular guide guarantees process reliability even under the harshest conditions

▶ Integrated position sensing

You can detect the gripper status safely via the motor current using your control system

▶ The simplest activation

The included control unit is controlled easily via plus and minus buttons, while you can optionally adjust the gripping force using the potentiometer

▶ THE BEST PRODUCT FOR YOUR APPLICATION



▶ Our products love the challenge!

Extreme conditions, all over the world—our tried and tested components and systems give you limitless possibilities:

Find the best product for your specific use:

www.zimmer-group.de

► BENEFITS IN DETAIL

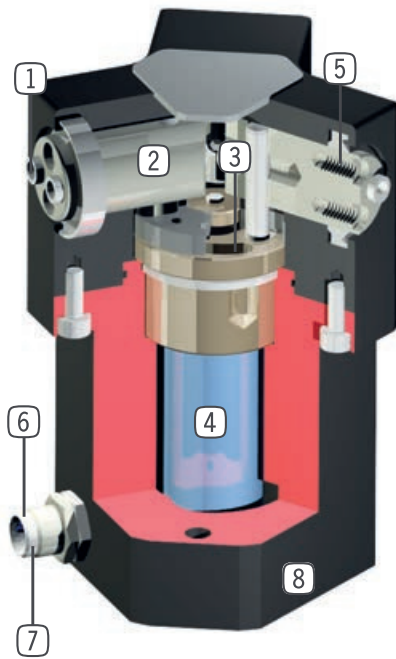

- ① **Removable centering sleeves**
 - quick and economical positioning of the gripper fingers
- ② **Gripper jaw**
 - hardened steel
 - individual gripper finger mounting
- ③ **Positively driven curve disc**
 - synchronized the movement of the gripper jaws
 - high force transfer
 - rapid stroke and force stroke (version with 6 mm stroke per jaw)
- ④ **Drive**
 - electric drive by 24 VDC step motor
- ⑤ **Guide**
 - sealed round guide for harsh environmental conditions
- ⑥ **Position sensing**
 - measured at the end of stroke via power increase on the motor
- ⑦ **Energy supply**
 - standardized interface M8 round plug connection signal control line (use only cable without diode)
- ⑧ **Robust, lightweight housing**
 - hard coated aluminium alloy

► FURTHER INFORMATION IS AVAILABLE ONLINE



► Technical Information

All information just a click away at: www.zimmer-group.de

Find data, illustrations, 3D models and Installation instructions for your installation size using the order number for your desired product.

Quick, clear and always current.



3-JAW CONCENTRIC GRIPPERS

SERIES GED1500

1

Series GED1500 / 3-Jaw Concentric Grippers / electric / Grippers

Installation Size: GED1502

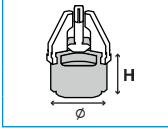

Dimension	
Ø [mm]	60
Height [mm]	85

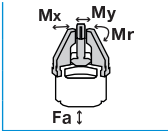

Force and moment			
Mr [Nm]	Mx [Nm]	My [Nm]	Fa [N]
4	5	4	200

Technical Data				
Stroke per jaw [mm]	Gripping force [N]		Weight [kg]	
	closing	opening		
GED1502	2	115	115	0.32

Order no.
GED1502

Gripping force diagram

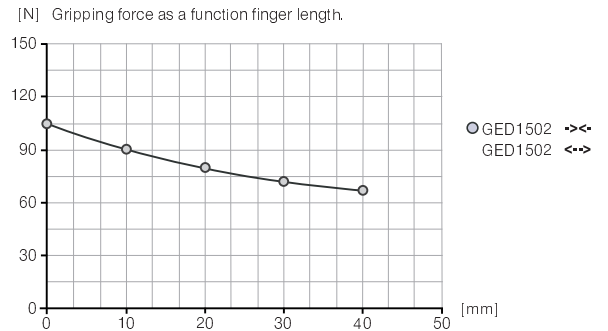

Installation Size: GED1506

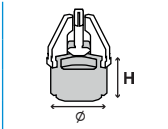

Dimension	
Ø [mm]	101
Height [mm]	121

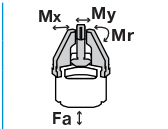

Force and moment			
Mr [Nm]	Mx [Nm]	My [Nm]	Fa [N]
15	20	15	600

Technical Data			
Stroke per jaw [mm]	Gripping force [N]		Weight [kg]
	closing	opening	
GED1506C	6	290	2
GED1506O	6	290	2

Order no.
GED1506C
GED1506O

Gripping force diagram

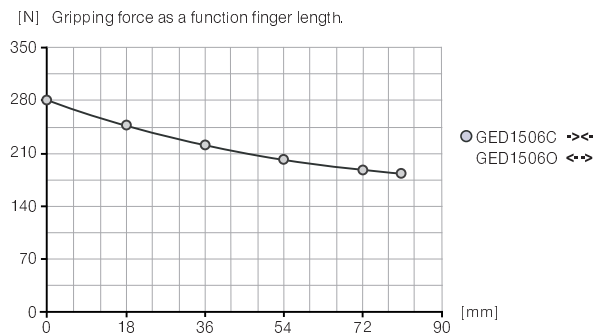

3-JAW CONCENTRIC GRIPPERS

SERIES GED1500

▶ ACCESSORIES

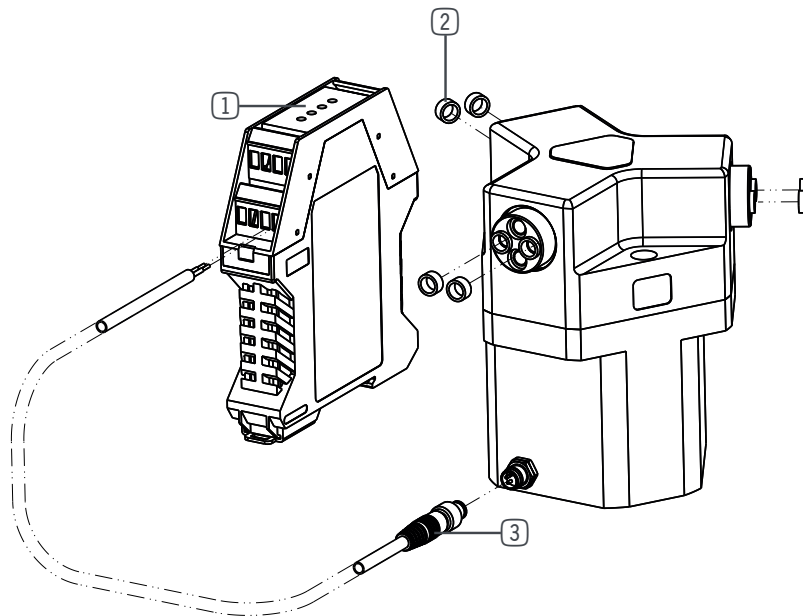

▶ Installation Size: GED1502

Pos.	Accessories	Order no.
③	Plug-in connector Straight Cable 5m - Socket M8 (female)	KAG500
③	Plug-in connector Angled Cable 5m - Socket M8 (female)	KAW500
Delivery contents		Order no.
①	Control	ELEGR01
②	Centering Disc	BDST02900

▶ Installation Size: GED1506

Pos.	Accessories	Order no.
③	Plug-in connector Straight Cable 5m - Socket M8 (female)	KAG500
③	Plug-in connector Angled Cable 5m - Socket M8 (female)	KAW500
Delivery contents		Order no.
①	Control	ELEGR04
②	Centering Disc	BDST40800