

2-JAW ANGULAR GRIPPERS

SERIES OVERVIEW

1

2-Jaw-Angular Grippers / pneumatic / Grippers

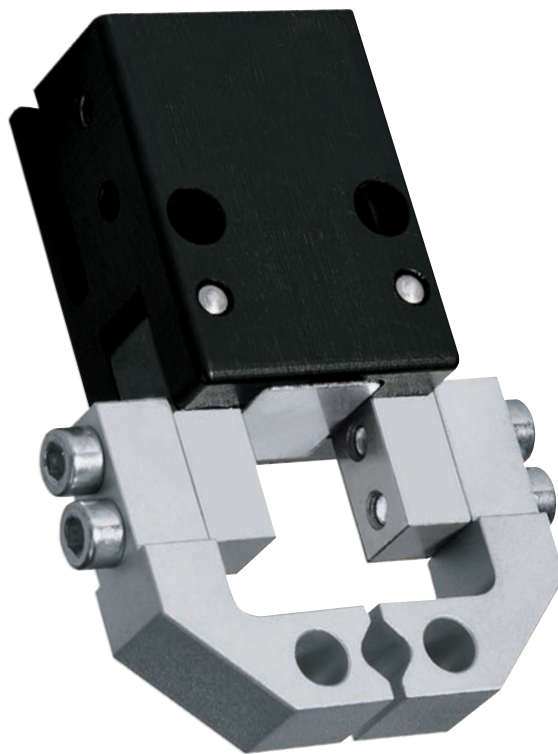

2-JAW ANGULAR GRIPPERS PNEUMATIC

▶ FURTHER INFORMATION on page 170

Series GZ1000	WORKING CONDITIONS		FUNCTIONALITY		PRICE	
	clean	dirty	-	+	+	++
	<input checked="" type="checkbox"/>	<input type="checkbox"/>	<input checked="" type="checkbox"/>	<input type="checkbox"/>	<input checked="" type="checkbox"/>	<input type="checkbox"/>

„The top of the line“

- ▶ Unique quality meets functionality
- ▶ Variable attachment
- ▶ Sensing with process reliability

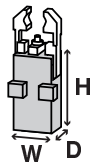

▶ Technical Data

Installation size	Stroke per Jaw [°]		Gripping moment [Nm]		Weight [kg]	
	from	to	from	to	from	to
GZ1020	8	8	0,5	0,5	0,015	0,03
GZ1030	11	11	1,6	1,6	0,046	0,063
GZ1040	10	10	4,4	4,4	0,105	0,125

▶ Dimension

Installation size	Width [mm]	Height [mm]	Depth [mm]	Ø Connection journal [mm]
GZ1020	20	62	10	10
GZ1030	30	81	15	15
GZ1040	40	101	20	20

▶ FURTHER INFORMATION on page 180

Series GZ	WORKING CONDITIONS		FUNCTIONALITY		PRICE	
	clean	dirty	-	+	+	++
	<input checked="" type="checkbox"/>	<input type="checkbox"/>	<input checked="" type="checkbox"/>	<input type="checkbox"/>	<input checked="" type="checkbox"/>	<input type="checkbox"/>

„The proven“

- ▶ Proven technology
- ▶ Fitted machinable gripper jaws
- ▶ Smooth stroke configuration

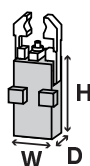

▶ Technical Data

Installation size	Stroke per Jaw [°]		Gripping force [N]		Weight [kg]	
	from	to	from	to	from	to
GZ8-16D	5	5	5,4	5,4	0,036	0,036
GZ8-16E	5	5	6	6	0,03	0,03
GZ11-18E	4,5	4,5	19,2	19,2	0,063	0,063
GZ18-23D	4	4	17,5	34,4	0,08	0,08
GZ25-35D	4	4	85	135	0,263	0,263
GZ25-35E	5	5	135	135	0,255	0,255
GZ25-35G	4	4	85	135	0,315	0,315
GZ55-65D	4	4	85	135	0,38	0,38

▶ Dimension

Installation size	Width [mm]	Height [mm]	Depth [mm]
GZ8-16D	18	72,5	11,6
GZ8-16E	18	62,6	11,6
GZ11-18E	24	66,5	14,6
GZ18-23D	29,7	75	14,6
GZ25-35D	39,4	115	24,4
GZ25-35E	39,4	115	24,4
GZ25-35G	30	111	24,4
GZ55-65D	69,4	115	24,4

2-JAW ANGULAR GRIPPERS

SERIES OVERVIEW

► FURTHER INFORMATION on page 184

WORKING CONDITIONS

FUNCTIONALITY

PRICE

Series MGW800	clean	dirty	-	+	+	++
						

„The economical“

- Concentration on the essentials
- High moment load
- Failure-free continuous operation

► Technical Data

Installation size	Stroke per Jaw [°]		Gripping moment [Nm]		Weight [kg]	
	from	to	from	to	from	to
MGW801	37,5	37,5	0,03	0,025	0,01	0,01
MGW802	37,5	37,5	0,05	0,045	0,015	0,015
MGW803	37,5	37,5	0,2	0,3	0,025	0,04
MGW804	37,5	37,5	0,35	0,5	0,05	0,08
MGW806	37,5	37,5	0,85	1,1	0,1	0,12
MGW808	37,5	37,5	1,55	2	0,18	0,19
MGW810	37,5	37,5	2,9	3,8	0,28	0,31
MGW812	37,5	37,5	4,1	5,2	0,4	0,45

► Dimension

Installation size	Width [mm]	Height [mm]	Depth [mm]
MGW801	12	20	10
MGW802	16	23	12
MGW803	20	39	14
MGW804	24	44	18
MGW806	30	46,5	23
MGW808	36	57	28
MGW810	42	69	33
MGW812	48	77	38

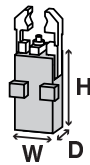

► FURTHER INFORMATION on page 192

WORKING CONDITIONS

FUNCTIONALITY

PRICE

Series GG1000	clean	dirty	-	+	+	++
						

„The Strong“

- High gripping force
- High moment load
- Failure-free continuous operation

► Technical Data

Installation size	Stroke per Jaw [°]		Gripping force [N]		Weight [kg]	
	from	to	from	to	from	to
GG1065	20	20	4150	4150	1,3	1,4
GG1085	20	20	9600	9600	2,8	3,2
GG1110	20	20	23200	36000	6,3	6,7
GG1140	20	20	23200	36000	12,4	13

► Dimension

Installation size	Width [mm]	Height [mm]	Depth [mm]
GG1065	100	88	65
GG1085	130	114,5	85
GG1110	170	150	110
GG1140	210	186,5	140

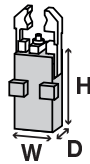

▶ FURTHER INFORMATION on page 196

WORKING CONDITIONS

FUNCTIONALITY

PRICE

Series GG4000		clean	dirty	-	+	+	++

„The sealed“

- ▶ Suitable for use under water
- ▶ Smooth stroke configuration
- ▶ Failure-free continuous operation

▶ Technical Data

Installation size	Stroke per Jaw [°]		Gripping moment [Nm]		Weight [kg]	
	from	to	from	to	from	to
GG4030	20	90	6,5	7	0,25	0,25
GG4040	20	90	13	15	0,5	0,5
GG4049	20	90	23	26	0,85	0,85
GG4058	20	90	46	53,5	1,4	1,4
GG4072	20	90	69	94	2,45	2,45
GG4084	20	90	135	156	4,5	4,5

▶ Dimension

Installation size	Width [mm]	Height [mm]	Depth [mm]
GG4030	44	87,5	32
GG4040	55	114	40
GG4049	66	134,5	48
GG4058	79	154	58
GG4072	95	183,5	72
GG4084	114	236	84

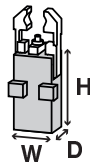

▶ FURTHER INFORMATION on page 206

WORKING CONDITIONS

FUNCTIONALITY

PRICE

Series GK		clean	dirty	-	+	+	++

„The compact“

- ▶ Proven technology
- ▶ Best force/installation space ratio
- ▶ Smooth stroke configuration

▶ Technical Data

Installation size	Stroke per Jaw [°]		Gripping force [N]		Weight [kg]	
	from	to	from	to	from	to
GK15		90	70	100	0,1	0,12
GK20		90	150	210	0,23	0,3
GK25		90	440	610	0,42	0,58
GK35		90	950	1250	0,9	1,2
GK40		90	1400	1820	1,7	2,2
GK50		90	3500	4250	3,5	4,1

▶ Dimension

Installation size	Width [mm]	Height [mm]	Depth [mm]
GK15	28	64,7	19,8
GK20	39	86,9	28
GK25	50	105,4	34,4
GK35	65	144,5	39,4
GK40	79	172	49,4
GK50	100	214	64

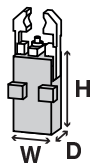

2-JAW ANGULAR GRIPPERS

SERIES GZ1000

▶ PRODUCT ADVANTAGES



“The top of the line”

▶ Unique quality meets functionality

This is one of the best angular grippers on the market, enabling you to make your application more cost-effective and functional

▶ Variable attachment

Decide for yourself whether you want use screws, lock-nuts or a toolkit clamping system for fastening

▶ Sensing with process reliability

Unlike many other established products on the market, you can even differentiate between “Component present” and “Component not present”

▶ THE BEST PRODUCT FOR YOUR APPLICATION



▶ Our products love the challenge!

Extreme conditions, all over the world—our tried and tested components and systems give you limitless possibilities:

Find the best product for your specific use:

www.zimmer-group.de

► BENEFITS IN DETAIL

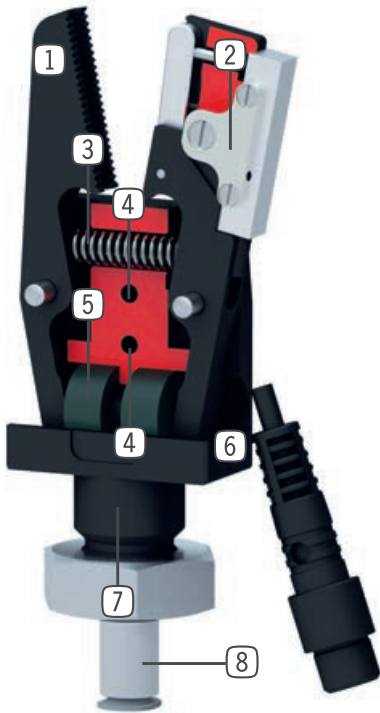

- ① Gripper jaw**
 - available in different versions
- ② Position sensing**
 - via inductive proximity switch
- ③ Return spring**
 - to open the gripper jaws
- ④ Mounting and positioning**
 - via thread / through-hole
- ⑤ Drive**
 - single-acting pneumatic cylinder
- ⑥ Housing**
 - hard coated surface for increased durability
- ⑦ Mounting and positioning**
 - via fit, thread and lock nut
- ⑧ Energy supply**

► FURTHER INFORMATION IS AVAILABLE ONLINE



► Technical Information

All information just a click away at: www.zimmer-group.de
 Find data, illustrations, 3D models and Installation instructions for your installation size using the order number for your desired product.
 Quick, clear and always current.



2-JAW ANGULAR GRIPPERS

SERIES GZ1000

1

2-Jaw-Angular Grippers / pneumatic / Grippers

Versions

e.g. order no.: **GZ1030-**

Version:

01 ▶ Serrated jaws without position sensing

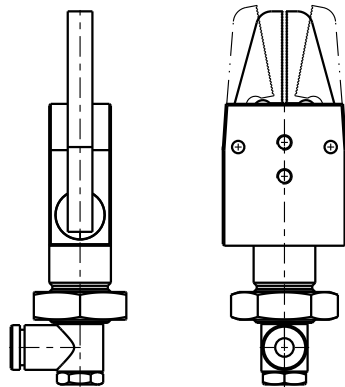

Version:

02 ▶ Serrated jaws without position sensing

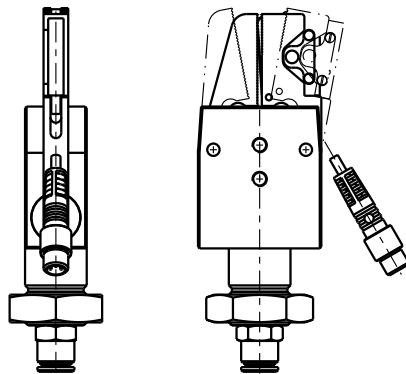

Version:

02 ▶ Basic version to mount customer specific fingers

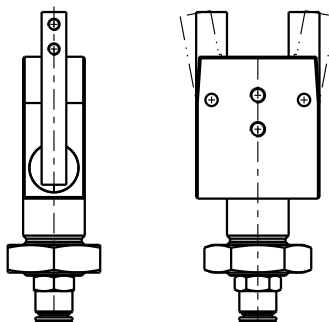

2-JAW ANGULAR GRIPPERS

SERIES GZ1000

1

Series GZ1000 / 2-Jaw Angular Grippers / pneumatic / Grippers

Installation Size: GZ1020

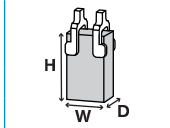

Dimension			
Width [mm]	Height [mm]	Depth [mm]	Ø Connection journal [mm]
20	62	10	10

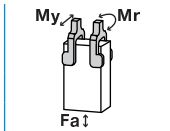

Force and moment			
Mr [Nm]	My [Nm]	Fa [N]	
1	0.6	60	

Technical Data*			
Stroke per jaw [°]	closing moment [Nm]	Weight [kg]	
8	0.5	0.017	
8	0.5	0.03	
8	0.5	0.015	

Order no.
GZ1020-01
GZ1020-02
GZ1020-03

*All data measured at 6 bar

Gripping force diagram

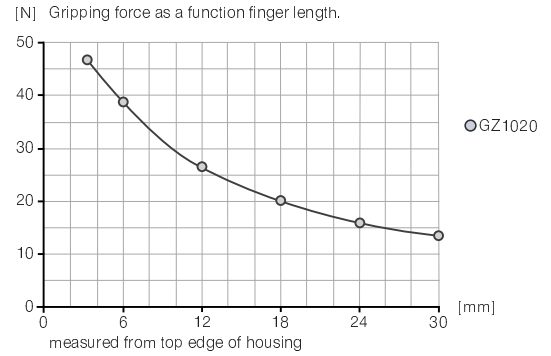

Installation Size: GZ1030

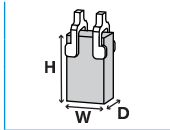

Dimension			
Width [mm]	Height [mm]	Depth [mm]	Ø Connection journal [mm]
30	81	15	15

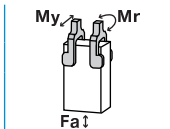

Force and moment			
Mr [Nm]	My [Nm]	Fa [N]	
1.5	1	110	

Technical Data*			
Stroke per jaw [°]	closing moment [Nm]	Weight [kg]	
11	1.6	0.05	
11	1.6	0.063	
11	1.6	0.046	

Order no.
GZ1030-01
GZ1030-02
GZ1030-03

*All data measured at 6 bar

Gripping force diagram

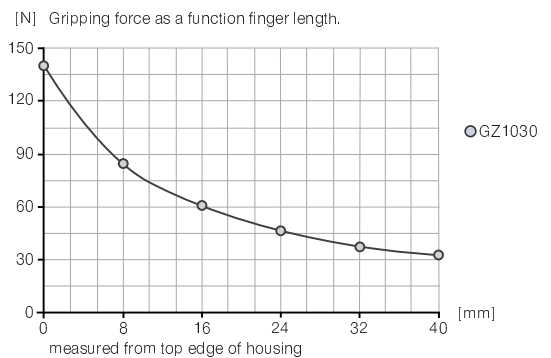

Installation Size: GZ1040

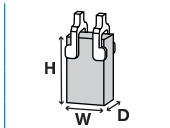

Dimension			
Width [mm]	Height [mm]	Depth [mm]	Ø Connection journal [mm]
40	101	20	20

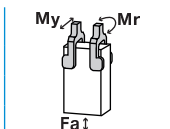

Force and moment			
Mr [Nm]	My [Nm]	Fa [N]	
2.5	2	200	

Technical Data*			
Stroke per jaw [°]	closing moment [Nm]	Weight [kg]	
10	4.4	0.11	
10	4.4	0.125	
10	4.4	0.105	

Order no.
GZ1040-01
GZ1040-02
GZ1040-03

*All data measured at 6 bar

Gripping force diagram

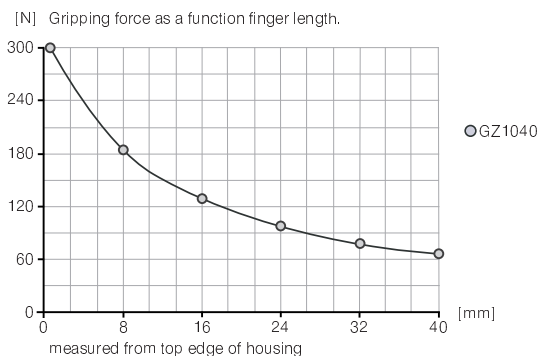

2-JAW ANGULAR ROTARY GRIPPERS

SERIES GZ1000

▶ ACCESSORIES

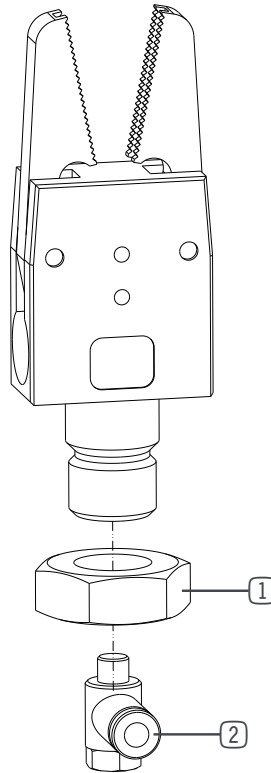

▶ Installation Size: GZ1020

Pos.	Accessories	Order no.
②	Straight Fittings - Quick Connect Style	GVM5
	Plug-in connector Straight Cable 5m - Socket M8 (female)	KAG500
	Plug-in connector customizable Straight - Connector M8	S8-G-3
	Plug-in connector customizable Straight - Connector M12	S12-G-3
	Delivery contents	Order no.
①	Locknut nut	C092610009
	Inductive Proximity Switch Cable 0,3 m - Connector M8	NJR05-E2SK

▶ Installation Size: GZ1040

Pos.	Accessories	Order no.
②	Straight Fittings - Quick Connect Style	GV1-8X6
	Plug-in connector Straight Cable 5m - Socket M8 (female)	KAG500
	Plug-in connector customizable Straight - Connector M8	S8-G-3
	Plug-in connector customizable Straight - Connector M12	S12-G-3
	Delivery contents	Order no.
①	Lockung nut	C093620159
	Inductive Proximity Switch Cable 0,3 m - Connector M8	NJR05-E2SK

▶ Installation Size: GZ1030

Pos.	Accessories	Order no.
②	Straight Fittings - Quick Connect Style	GVM5
	Plug-in connector Straight Cable 5m - Socket M8 (female)	KAG500
	Plug-in connector customizable Straight - Connector M8	S8-G-3
	Plug-in connector customizable Straight - Connector M12	S12-G-3
	Delivery contents	Order no.
①	Lockung nut	C093614159
	Inductive Proximity Switch Cable 0,3 m - Connector M8	NJR05-E2SK

2-JAW ANGULAR GRIPPERS SERIES GZ

▶ PRODUCT ADVANTAGES

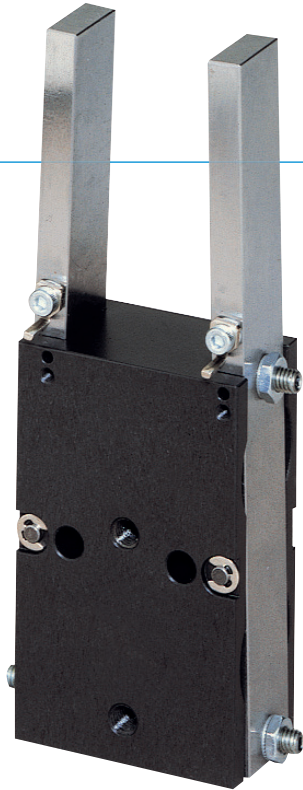

“The proven”

▶ Proven technology

We have more than 20 years of proven reliability, which ensures uninterrupted production for you

▶ Fitted machinable gripper jaws

By machining the supplied gripper jaws, you can quickly acquire a gripper jaw customised to your needs

▶ Smooth stroke configuration

Configure your own unique stroke - regardless of the gripper jaws!

▶ THE BEST PRODUCT FOR YOUR APPLICATION



▶ Our products love the challenge!

Extreme conditions, all over the world—our tried and tested components and systems give you limitless possibilities:

Find the best product for your specific use:

www.zimmer-group.de

► BENEFITS IN DETAIL

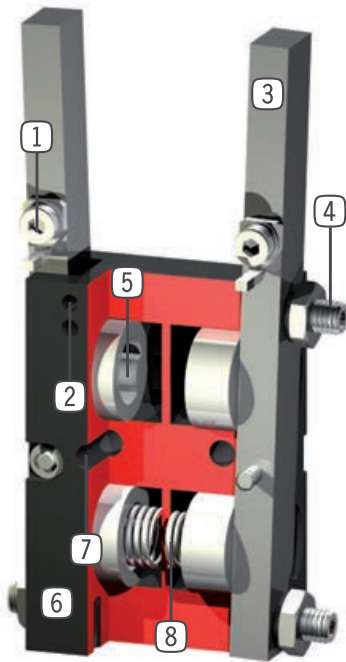

- ① **Adjustable switch cam**
 - direct sensing of gripper jaw movement
- ② **Fixing for mounting block**
 - for inductive proximity switch
- ③ **Steel (C45K) gripper jaw**
 - can be machined to suit individual applications and hardened
- ④ **Adjusting screw**
 - Infinitely adjustable opening stroke
 - setting of gripper jaw for exact adjustment of the workpiece
- ⑤ **Drive**
 - direct drive via plunger pistons
- ⑥ **Robust, lightweight housing**
 - hard coated aluminium alloy
- ⑦ **Mounting and positioning**
 - mounting possible from several sides for versatile positioning
- ⑧ **Integrated gripping force safety device**
 - integrated into piston chamber as energy storage (from GZ18-23D up to GZ55-65D)

► FURTHER INFORMATION IS AVAILABLE ONLINE



► Technical Information

All information just a click away at: www.zimmer-group.de

Find data, illustrations, 3D models and Installation instructions for your installation size using the order number for your desired product.

Quick, clear and always current.





2-JAW ANGULAR GRIPPERS SERIES GZ

1

Series GZ / 2-Jaw Angular Grippers / pneumatic / Grippers

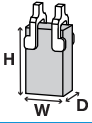
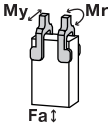
Installation Size: GZ8-16D



	▶ Dimension			
	Width [mm]	Height [mm]	Depth [mm]	
	18	72.5	11.6	
	▶ Force and moment			
	Mr [Nm]	My [Nm]	Fa [N]	
	0.3	0.5	30	
	▶ Technical Data*			
	Stroke per jaw [°]	Gripping force [N]		Weight [kg]
		opening	closing	
Order no.	5	5.4	5.4	0.036
GZ8-16D				

*All data measured at 6 bar

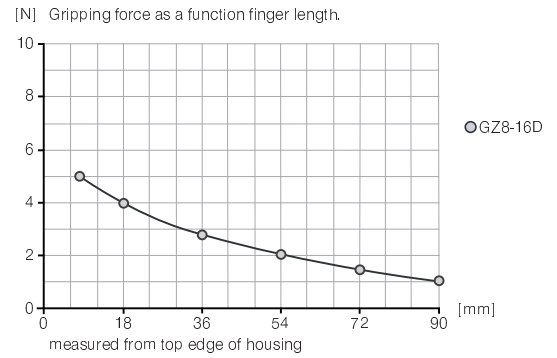
▶ Gripping force diagram

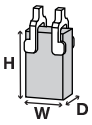
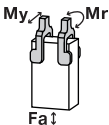

Installation Size: GZ8-16E



	▶ Dimension			
	Width [mm]	Height [mm]	Depth [mm]	
	18	62.6	11.6	
	▶ Force and moment			
	Mr [Nm]	My [Nm]	Fa [N]	
	0.3	0.5	30	
	▶ Technical Data*			
	Stroke per jaw [°]	Gripping force [N]		Weight [kg]
		opening	closing	
Order no.	5		6	0.03
GZ8-16E				

*All data measured at 6 bar

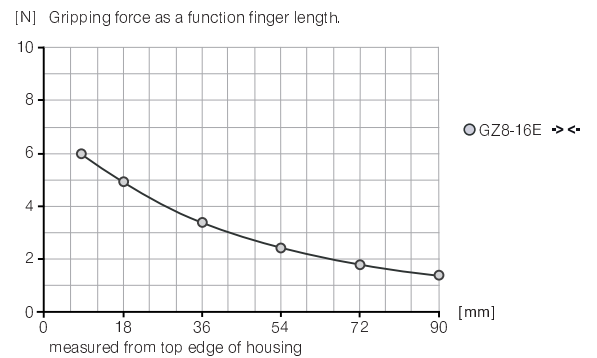
▶ Gripping force diagram

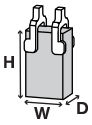
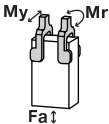

Installation Size: GZ11-18E

	▶ Dimension			
	Width [mm]	Height [mm]	Depth [mm]	
	24	66.5	14.6	
	▶ Force and moment			
	Mr [Nm]	My [Nm]	Fa [N]	
	0.3	0.5	30	
	▶ Technical Data*			
	Stroke per jaw [°]	Gripping force [N]		Weight [kg]
		opening	closing	
Order no.	4.5		19.2	0.063
GZ11-18E				

*All data measured at 6 bar

▶ Gripping force diagram

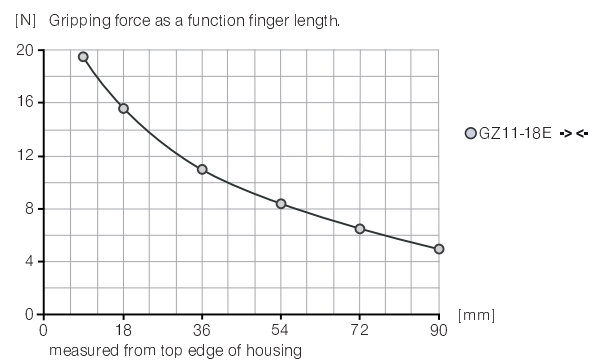

Installation Size: GZ18-23D

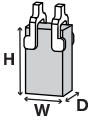

Dimension

Width [mm]	Height [mm]	Depth [mm]
29.7	75	14.6

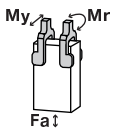

Force and moment

Mr [Nm]	My [Nm]	Fa [N]
0.3	0.5	30

Technical Data*

Order no.	Stroke per jaw [°]	Gripping force [N]		Weight [kg]
		opening	closing	
GZ18-23D	4	17.5	34.4	0.08

*All data measured at 6 bar

Gripping force diagram

[N] Gripping force as a function finger length.

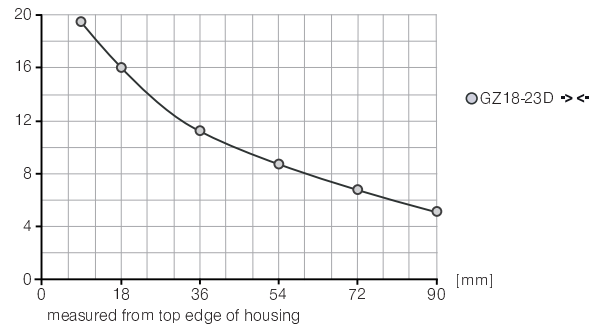

Installation Size: GZ25-35E

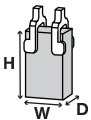

Dimension

Width [mm]	Height [mm]	Depth [mm]
39.4	115	24.4

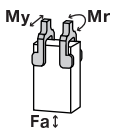

Force and moment

Mr [Nm]	My [Nm]	Fa [N]
0.5	0.8	50

Technical Data*

Order no.	Stroke per jaw [°]	Gripping force [N]		Weight [kg]
		opening	closing	
GZ25-35E	5	135	135	0.255

*All data measured at 6 bar

Gripping force diagram

[N] Gripping force as a function finger length.

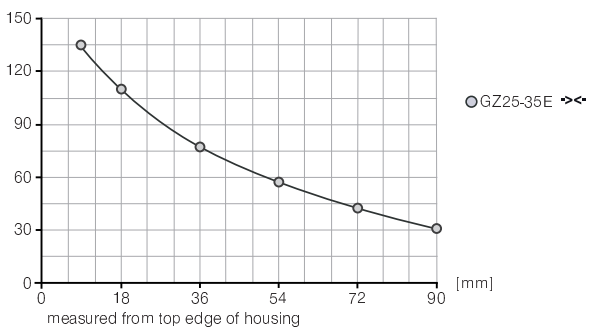

Installation Size: GZ25-35G

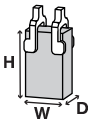

Dimension

Width [mm]	Height [mm]	Depth [mm]
30	111	24.4

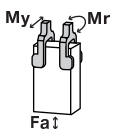

Force and moment

Mr [Nm]	My [Nm]	Fa [N]
0.5	0.8	50

Technical Data*

Order no.	Stroke per jaw [°]	Gripping force [N]		Weight [kg]
		opening	closing	
GZ25-35G	4	85	135	0.315

*All data measured at 6 bar

Gripping force diagram

[N] Gripping force as a function finger length.

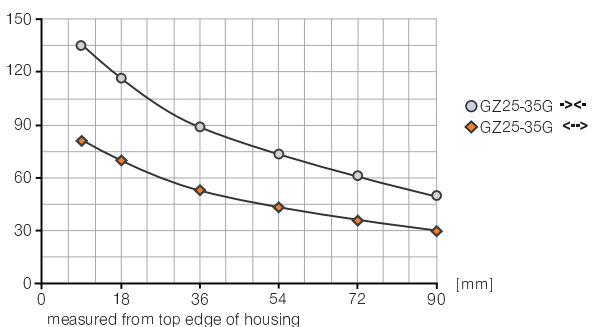

2-JAW ANGULAR GRIPPERS SERIES GZ

1

Series GZ / 2-Jaw Angular Grippers / pneumatic / Grippers

Installation Size: GZ25-35D

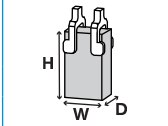

Dimension

Width [mm]	Height [mm]	Depth [mm]
39.4	115	24.4

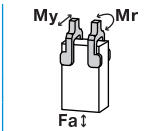

Force and moment

Mr [Nm]	My [Nm]	Fa [N]
0.5	0.8	50

Technical Data*

Order no.	Stroke per jaw [°]	Gripping force [N]		Weight [kg]
		opening	closing	
GZ25-35D	4	85	135	0.263

*All data measured at 6 bar

Gripping force diagram

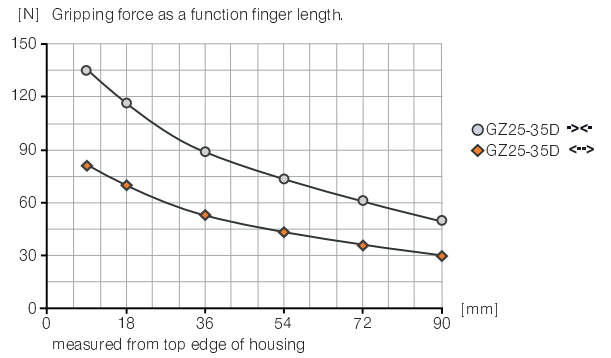

Installation Size: GZ55-65D

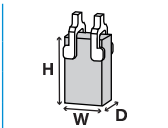

Dimension

Width [mm]	Height [mm]	Depth [mm]
69.4	115	24.4

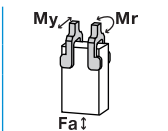

Force and moment

Mr [Nm]	My [Nm]	Fa [N]
0.5	0.8	50

Technical Data*

Order no.	Stroke per jaw [°]	Gripping force [N]		Weight [kg]
		opening	closing	
GZ55-65D	4	85	135	0.38

*All data measured at 6 bar

Gripping force diagram

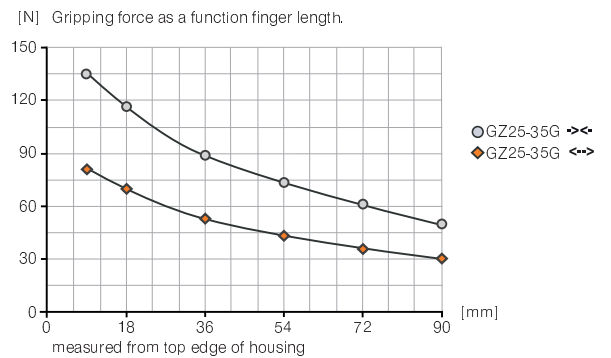

ARE YOU ALREADY FAMILIAR WITH OUR EXPERTISE?

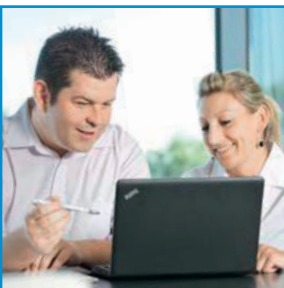

- ▶ TEAMS OF EXPERTS WITH INDUSTRY EXPERIENCE
- ▶ INTERNATIONALLY NETWORKED THROUGH WORLD-WIDE LOCATIONS
- ▶ THE HIGHEST QUALITY FOR ALL PRODUCTS AND SERVICES
- ▶ PRECISELY TAILORED AND ADVANCED PROCESS SOLUTIONS
- ▶ CONSTANT DEVELOPMENT OF OUR INDUSTRY EXPERTISE

2-JAW ANGULAR GRIPPERS SERIES GZ

▶ ACCESSORIES

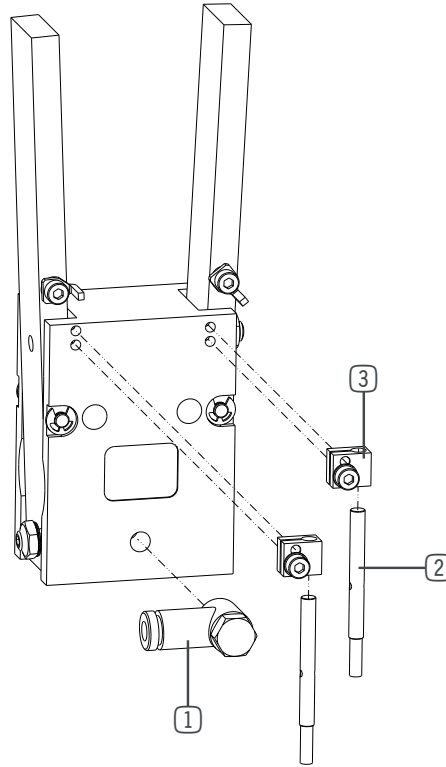

▶ Installation Size: GZ8-16E

Pos.	Accessories	Order no.
①	Straight Fittings - Quick Connect Style	GVM5
②	Inductive proximity switch - Cable 5 m	NJ3-E2
②	Inductive Proximity Switch Cable 0,3 m - Connector M8	NJ3-E2SK
③	Mounting block	KB3M
	Plug-in connector Straight Cable 5m - Socket M8 (female)	KAG500
	Plug-in connector customizable Straight - Connector M8	S8-G-3

▶ Installation Size: GZ8-16D

Pos.	Accessories	Order no.
①	Straight Fittings - Quick Connect Style	GVM5
②	Inductive proximity switch - Cable 5 m	NJ3-E2
②	Inductive Proximity Switch Cable 0,3 m - Connector M8	NJ3-E2SK
③	Mounting block	KB3M
	Plug-in connector Straight Cable 5m - Socket M8 (female)	KAG500
	Plug-in connector customizable Straight - Connector M8	S8-G-3
	Plug-in connector customizable Straight - Connector M12	S12-G-3

▶ Installation Size: GZ11-18E

Pos.	Accessories	Order no.
①	Straight Fittings - Quick Connect Style	GVM5
②	Inductive proximity switch - Cable 5 m	NJ3-E2
②	Inductive Proximity Switch Cable 0,3 m - Connector M8	NJ3-E2SK
③	Mounting block	KB3M
	Plug-in connector Straight Cable 5m - Socket M8 (female)	KAG500
	Plug-in connector customizable Straight - Connector M8	S8-G-3
	Plug-in connector customizable Straight - Connector M12	S12-G-3

▶ Installation Size: GZ18-23D

Pos.	Accessories	Order no.
①	Straight Fittings - Quick Connect Style	GVM5
②	Inductive proximity switch - Cable 5 m	NJ3-E2
②	Inductive Proximity Switch Cable 0,3 m - Connector M8	NJ3-E2SK
③	Mounting block	KB3M
	Plug-in connector Straight Cable 5m - Socket M8 (female)	KAG500
	Plug-in connector customizable Straight - Connector M8	S8-G-3
	Plug-in connector customizable Straight - Connector M12	S12-G-3

► Installation Size: **GZ25-35E**

Pos.	Accessories	Order no.
①	Straight Fittings - Quick Connect Style	GVM5
②	Inductive proximity switch - Cable 5 m	NJ3-E2
②	Inductive Proximity Switch Cable 0,3 m - Connector M8	NJ3-E2SK
③	Mounting block	KB3M
	Plug-in connector Straight Cable 5m - Socket M8 (female)	KAG500
	Plug-in connector customizable Straight - Connector M8	S8-G-3
	Plug-in connector customizable Straight - Connector M12	S12-G-3

► Installation Size: **GZ25-35G**

Pos.	Accessories	Order no.
①	Straight Fittings - Quick Connect Style	GVM5
②	Inductive proximity switch - Cable 5 m	NJ3-E2
②	Inductive Proximity Switch Cable 0,3 m - Connector M8	NJ3-E2SK
③	Mounting block	KB3M
	Plug-in connector Straight Cable 5m - Socket M8 (female)	KAG500
	Plug-in connector customizable Straight - Connector M8	S8-G-3
	Plug-in connector customizable Straight - Connector M12	S12-G-3

► Installation Size: **GZ25-35D**

Pos.	Accessories	Order no.
①	Straight Fittings - Quick Connect Style	GVM5
②	Inductive proximity switch - Cable 5 m	NJ3-E2
②	Inductive Proximity Switch Cable 0,3 m - Connector M8	NJ3-E2SK
③	Mounting block	KB3M
	Plug-in connector Straight Cable 5m - Socket M8 (female)	KAG500
	Plug-in connector customizable Straight - Connector M8	S8-G-3
	Plug-in connector customizable Straight - Connector M12	S12-G-3

► Installation Size: **GZ55-65D**

Pos.	Accessories	Order no.
①	Straight Fittings - Quick Connect Style	GVM5
②	Inductive proximity switch - Cable 5 m	NJ3-E2
②	Inductive Proximity Switch Cable 0,3 m - Connector M8	NJ3-E2SK
③	Mounting block	KB3M
	Plug-in connector Straight Cable 5m - Socket M8 (female)	KAG500
	Plug-in connector customizable Straight - Connector M8	S8-G-3
	Plug-in connector customizable Straight - Connector M12	S12-G-3

2-JAW ANGULAR GRIPPERS

SERIES MGW800

▶ PRODUCT ADVANTAGES

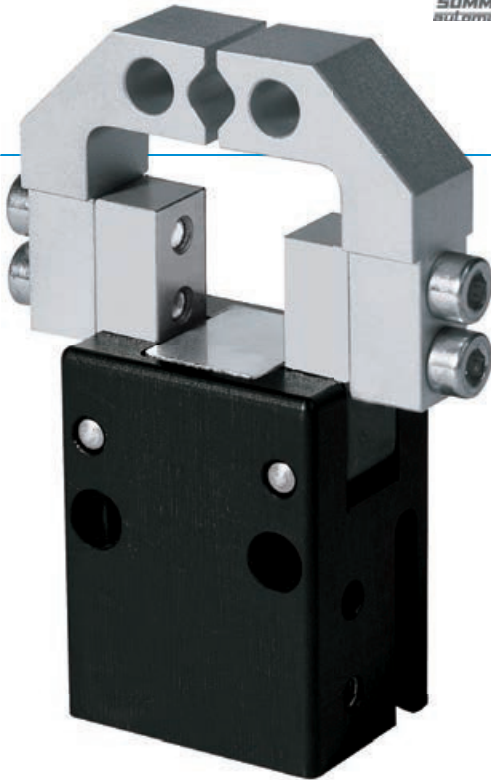

“The economical”

▶ Concentration on the essentials

The most economic type of gripping: This is how you reduce your production costs

▶ High moment load

The optimally designed angular gear box provides the highest durability for your application

▶ Failure-free continuous operation

Our uncompromising “Made in Germany” quality guarantees up to 10 million maintenance-free gripping cycles

▶ THE BEST PRODUCT FOR YOUR APPLICATION

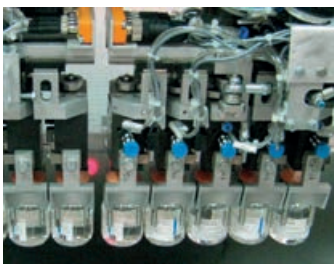

▶ Our products love the challenge!

Extreme conditions, all over the world—our tried and tested components and systems give you limitless possibilities:

Find the best product for your specific use:

www.zimmer-group.de

► BENEFITS IN DETAIL

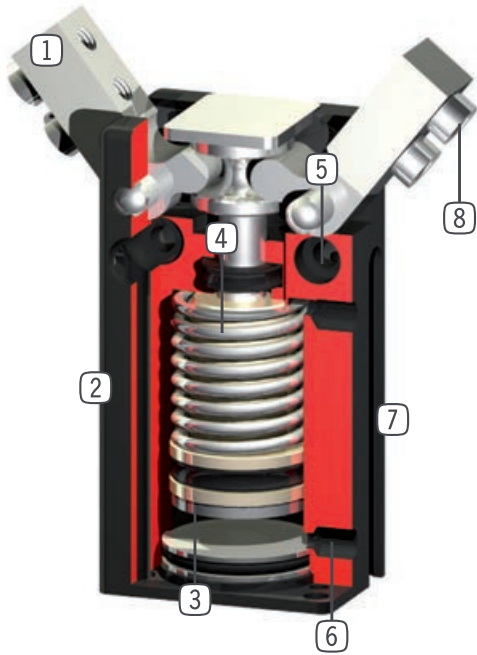

- ① **Gripper jaw**
- individual gripper finger mounting
- ② **Robust, lightweight housing**
- hard coated aluminium alloy
- ③ **Position sensing**
- permanent magnet for direct monitoring of piston movement
- ④ **Integrated gripping force safety device**
- spring integrated into cylinder as energy storage (from size 803 upwards)
- ⑤ **Mounting and positioning**
- mounting possible from several sides for versatile positioning
- ⑥ **Energy supply**
- possible from several sides
- ⑦ **Sensing slot**
- mounting and positioning of magnetic field sensors
- ⑧ **Removable centering sleeves**
- quick and economical positioning of the gripper fingers

► FURTHER INFORMATION IS AVAILABLE ONLINE



► Technical Information

All information just a click away at: www.zimmer-group.de
Find data, illustrations, 3D models and Installation instructions for your installation size using the order number for your desired product.
Quick, clear and always current.

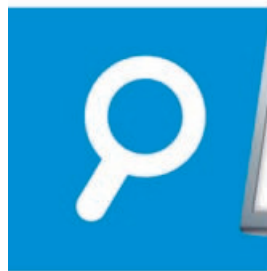

2-JAW ANGULAR GRIPPERS

SERIES MGW800

1

Series MGW800 / 2-Jaw Angular Grippers / pneumatic / Grippers

Installation Size: MGW801

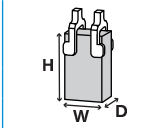

Dimension

Width [mm]	Height [mm]	Depth [mm]
12	20	10

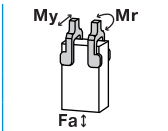

Force and moment

Mr [Nm]	My [Nm]	Fa [N]
0.2	0.2	37

Technical Data*

Stroke per jaw [°]	Gripping moment [Nm]		Weight [kg]
	opening	closing	
37.5	0.03	0.025	0.01

Order no.

MGW801N

*All data measured at 6 bar

Gripping force diagram

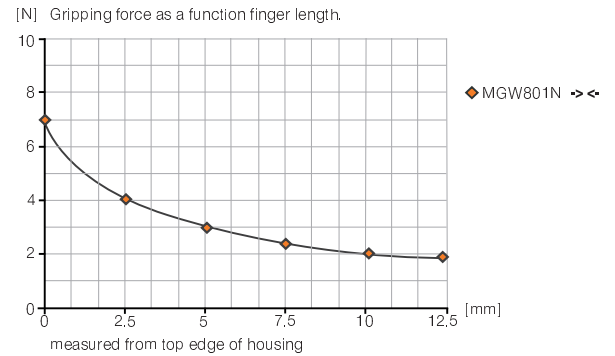

Installation Size: MGW802

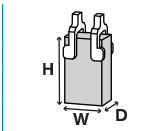

Dimension

Width [mm]	Height [mm]	Depth [mm]
16	23	12

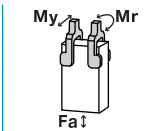

Force and moment

Mr [Nm]	My [Nm]	Fa [N]
0.3	0.3	60

Technical Data*

Stroke per jaw [°]	Gripping moment [Nm]		Weight [kg]
	opening	closing	
37.5	0.05	0.045	0.015

Order no.

MGW802N

*All data measured at 6 bar

Gripping force diagram

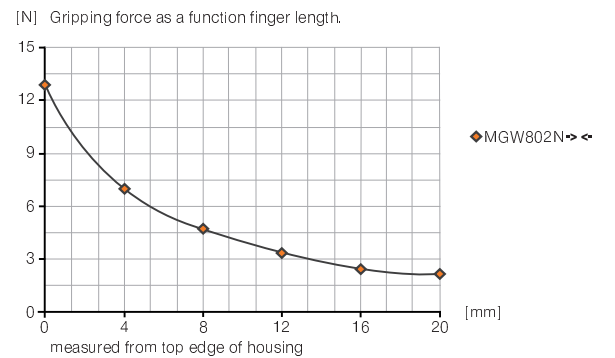

Installation Size: MGW803

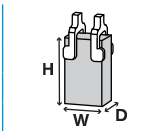

Dimension

Width [mm]	Height** [mm]	Depth [mm]
20	39	14

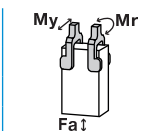

Force and moment

Mr [Nm]	My [Nm]	Fa [N]
0.4	0.4	90

Technical Data*

Stroke per jaw [°]	Gripping moment [Nm]		Weight [kg]
	opening	closing	
37.5	0.23	0.2	0.025
37.5		0.3	0.04

Order no.

MGW803N

MGW803NC

*All data measured at 6 bar

** Version with gripping force protection (NC)

Gripping force diagram

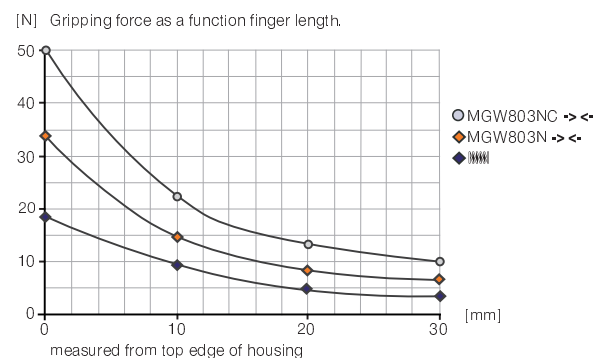

Installation Size: MGW804

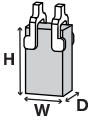

Dimension

Width [mm]	Height** [mm]	Depth [mm]
24	44	18

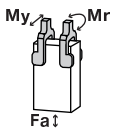

Force and moment

Mr [Nm]	My [Nm]	Fa [N]
0.5	0.5	150

Technical Data*

Stroke per jaw [°]	Gripping moment [Nm]		Weight [kg]
	opening	closing	
37.5	0.41	0.35	0.05
37.5		0.5	0.08

Order no.

MGW804N

MGW804NC

*All data measured at 6 bar

**Version with gripping force protection (NC)

Gripping force diagram

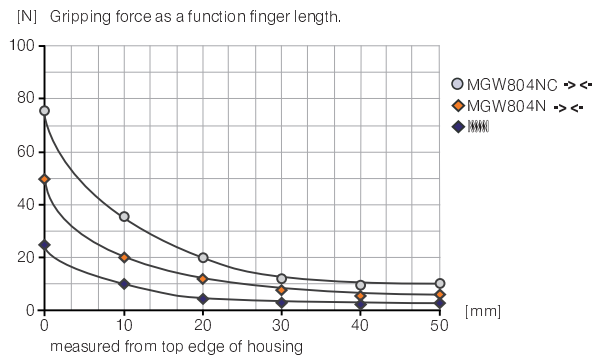

Installation Size: MGW806

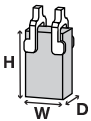

Dimension

Width [mm]	Height** [mm]	Depth [mm]
30	46.5	23

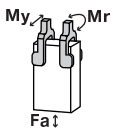

Force and moment

Mr [Nm]	My [Nm]	Fa [N]
0.7	0.7	260

Technical Data*

Stroke per jaw [°]	Gripping moment [Nm]		Weight [kg]
	opening	closing	
37.5	1.02	0.85	0.1
37.5		1.1	0.12

Order no.

MGW806N

MGW806NC

*All data measured at 6 bar

**Version with gripping force protection (NC)

Gripping force diagram

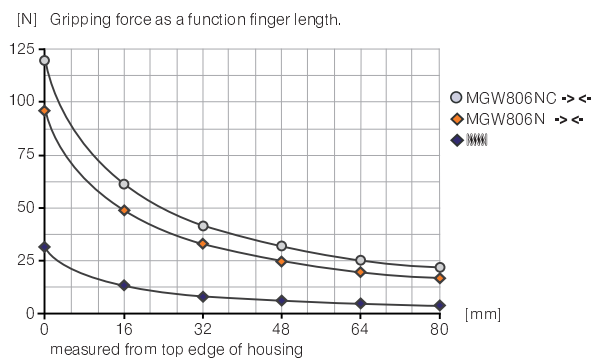

Installation Size: MGW808

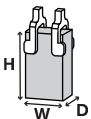

Dimension

Width [mm]	Height** [mm]	Depth [mm]
36	57	28

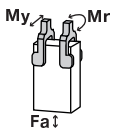

Force and moment

Mr [Nm]	My [Nm]	Fa [N]
1.3	1.3	430

Technical Data*

Stroke per jaw [°]	Gripping moment [Nm]		Weight [kg]
	opening	closing	
37.5	1.76	1.55	0.18
37.5		2	0.19

Order no.

MGW808N

MGW808NC

*All data measured at 6 bar

**Version with gripping force protection (NC)

Gripping force diagram

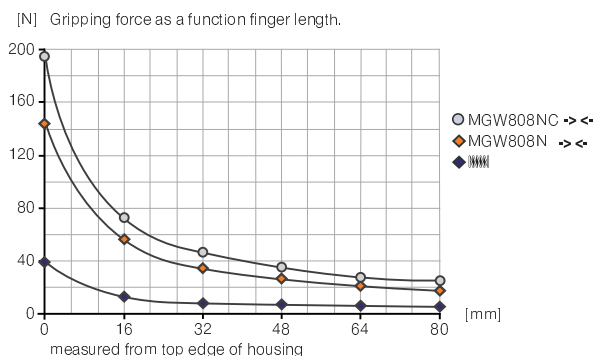

2-JAW ANGULAR GRIPPERS

SERIES MGW800

1

Series MGW 800 / 2-Jaw Angular grippers / pneumatic / Grippers

Installation Size: MGW810

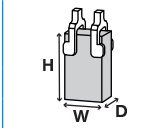

Dimension

Width [mm]	Height* [mm]	Depth [mm]
42	69	33

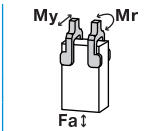

Force and moment

Mr [Nm]	My [Nm]	Fa [N]
1.6	1.6	500

Technical Data*

Order no.	Stroke per jaw [°]	Gripping moment [Nm]		Weight [kg]
		opening	closing	
MGW810N	37.5	3.3	2.9	0.28
MGW810NC	37.5		3.8	0.31

*All data measured at 6 bar

** Version with gripping force protection (NC)

Gripping force diagram

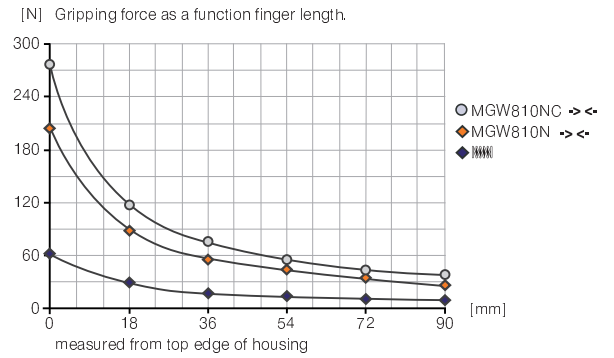

Installation Size: MGW812

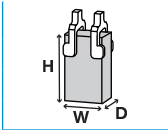

Dimension

Width [mm]	Height* [mm]	Depth [mm]
48	77	38

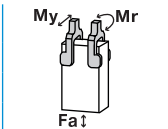

Force and moment

Mr [Nm]	My [Nm]	Fa [N]
2.3	2.3	720

Technical Data*

Order no.	Stroke per jaw [°]	Gripping moment [Nm]		Weight [kg]
		opening	closing	
MGW812N	37.5	4.55	4.1	0.4
MGW812NC	37.5		5.2	0.45

*All data measured at 6 bar

** Version with gripping force protection (NC)

Gripping force diagram

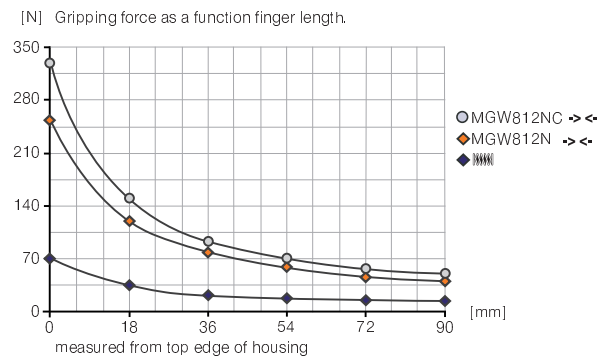

2-JAW ANGULAR GRIPPERS

SERIES MGW800

▶ ACCESSORIES

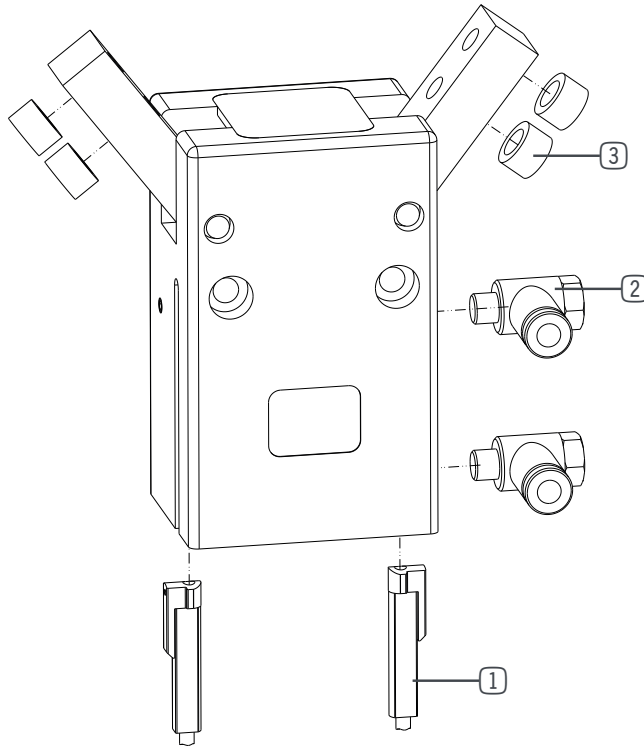

▶ Installation Size: **MGW801**

Pos.	Accessories	Order no.
②	Straight Fittings - Barb Style Connection	GVM3
②	Angled Fittings - Barb Style Connection	WVM3
Delivery contents		Order no.
③	Centering Disc	BDST80100

▶ Installation Size: **MGW802**

Pos.	Accessories	Order no.
②	Straight Fittings - Barb Style Connection	GVM3
②	Angled Fittings - Barb Style Connection	WVM3
Delivery contents		Order no.
③	Centering Disc	BDST80200

▶ Installation Size: **MGW803**

Pos.	Accessories	Order no.
①	Magnetic field sensor Angled Cable 5 m	MFS103KHC
①	Magnetic field sensor Angled Cable 0,3 m - Connector M8	MFS103SKHC
①	Magnetic field sensor Straight Cable 5 m	MFS204KHC
①	Magnetic field sensor Straight Cable 0,3 m - Connector M8	MFS204SKHC
②	Straight Fittings - Barb Style Connection	GVM3
②	Angled Fittings - Barb Style Connection	WVM3
Delivery contents		Order no.
③	Centering Disc	BDST80320

▶ Installation Size: **MGW804**

Pos.	Accessories	Order no.
①	Magnetic field sensor Angled Cable 5 m	MFS103KHC
①	Magnetic field sensor Angled Cable 0,3 m - Connector M8	MFS103SKHC
①	Magnetic field sensor Straight Cable 5 m	MFS204KHC
①	Magnetic field sensor Straight Cable 0,3 m - Connector M8	MFS204SKHC
②	Straight Fittings - Barb Style Connection	GVM3
②	Angled Fittings - Barb Style Connection	WVM3
Delivery contents		Order no.
③	Centering Disc	BDST40400

▶ Installation Size: **MGW806**

Pos.	Accessories	Order no.
①	Magnetic field sensor Angled Cable 5 m	MFS103KHC
①	Magnetic field sensor Angled Cable 0,3 m - Connector M8	MFS103SKHC
①	Magnetic field sensor Straight Cable 5 m	MFS204KHC
①	Magnetic field sensor Straight Cable 0,3 m - Connector M8	MFS204SKHC
②	Straight Fittings - Barb Style Connection	GVM3
②	Angled Fittings - Barb Style Connection	WVM3
Delivery contents		Order no.
③	Centering Disc	BDST40600

► Installation Size: **MGW808**

Pos.	Accessories	Order no.
①	Magnetic field sensor Angled Cable 5 m	MFS103KHC
①	Magnetic field sensor Angled Cable 0,3 m - Connector M8	MFS103SKHC
①	Magnetic field sensor Straight Cable 5 m	MFS204KHC
①	Magnetic field sensor Straight Cable 0,3 m - Connector M8	MFS204SKHC
②	Straight Fittings - Barb Style Connection	GVM3
②	Angled Fittings - Barb Style Connection	WVM3
	Delivery contents	Order no.
③	Centering Disc	BDST40600

► Installation Size: **MGW810**

Pos.	Accessories	Order no.
①	Magnetic field sensor Angled Cable 5 m	MFS103KHC
①	Magnetic field sensor Angled Cable 0,3 m - Connector M8	MFS103SKHC
①	Magnetic field sensor Straight Cable 5 m	MFS204KHC
①	Magnetic field sensor Straight Cable 0,3 m - Connector M8	MFS204SKHC
②	Straight Fittings - Quick Connect Style	GVM5
	Delivery contents	Order no.
③	Centering Disc	BDST07540

► Installation Size: **MGW812**

Pos.	Accessories	Order no.
①	Magnetic field sensor Angled Cable 5 m	MFS103KHC
①	Magnetic field sensor Angled Cable 0,3 m - Connector M8	MFS103SKHC
①	Magnetic field sensor Straight Cable 5 m	MFS204KHC
①	Magnetic field sensor Straight Cable 0,3 m - Connector M8	MFS204SKHC
②	Straight Fittings - Quick Connect Style	GVM5
	Delivery contents	Order no.
③	Centering Disc	BDST07540

2-JAW ANGULAR GRIPPERS

SERIES GG1000

▶ PRODUCT ADVANTAGES

SOMMER
automatic **S**



“The sturdy”

- ▶ **High gripping force**
Using the high gripping force, you can safely handle even the heaviest workpieces
- ▶ **High moment load**
The generously scaled angular gear box provides the highest possible durability for your application
- ▶ **Failure-free continuous operation**
Our uncompromising “Made in Germany” quality guarantees up to 10 million maintenance-free gripping cycles

▶ THE BEST PRODUCT FOR YOUR APPLICATION



- ▶ **Our products love the challenge!**
Extreme conditions, all over the world—our tried and tested components and systems give you limitless possibilities:
Find the best product for your specific use:
www.zimmer-group.de

1

Series GG1000 / 2-Jaw Angular Grippers / pneumatic / Grippers

► BENEFITS IN DETAIL

- ① **Cam-switch and mounting block**
- for position sensing
- ② **Robust, lightweight housing**
- hard coated aluminium alloy
- ③ **Sensing slot**
- groove for positioning of the magnetic field sensor
- ④ **Permanent magnet**
- sensing of the piston setting position via magnetic field sensors
- ⑤ **Positively driven lever mechanism**
- synchronized the movement of the gripper jaws
- ⑥ **Integrated gripping force safety device**
- spring integrated into cylinder as energy storage
- ⑦ **Drive**
- double-acting pneumatic cylinder
- ⑧ **Removable centering sleeves**
- quick and economical positioning of the gripper fingers

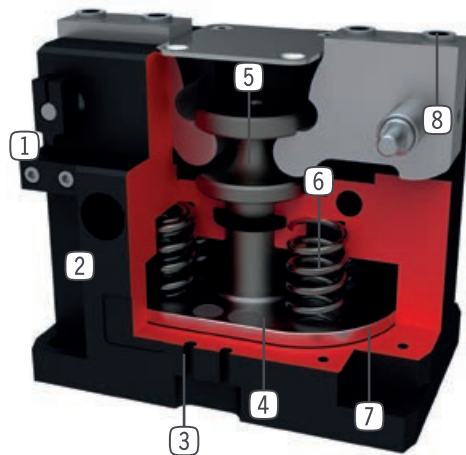

► FURTHER INFORMATION IS AVAILABLE ONLINE



► Technical Information

All information just a click away at: www.zimmer-group.de
Find data, illustrations, 3D models and Installation instructions for your installation size using the order number for your desired product.
Quick, clear and always current.

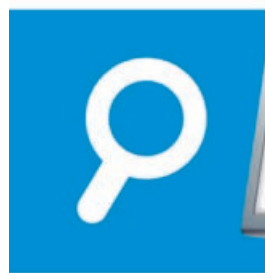

2-JAW ANGULAR GRIPPERS

SERIES GG1000

1

Series GG1000 / 2-Jaw Angular Grippers / pneumatic / Grippers

Installation Size: GG1065

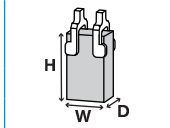

Dimension

Width [mm]	Height [mm]	Depth [mm]
100	88	65

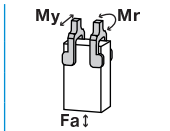

Force and moment

Mr [Nm]	My [Nm]	Fa [N]
20	20	330

Technical Data*

Order no.	Stroke per jaw [°]	Gripping moment in closing max. [Nm]	Gripping force in closing max. [N]	Weight [kg]
GG1065NC	20	55	4150	1.3
GG1065FNC	20	55	4150	1.4

*All data measured at 6 bar

Gripping moment diagram

[Nm] Gripping force as a function of opening angle.

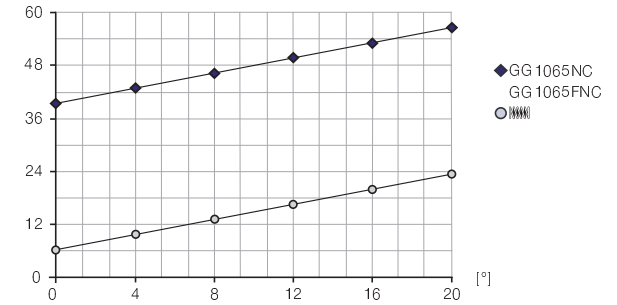

Installation Size: GG1085

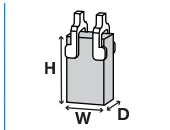

Dimension

Width [mm]	Height [mm]	Depth [mm]
130	114.5	85

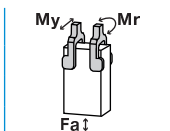

Force and moment

Mr [Nm]	My [Nm]	Fa [N]
40	50	600

Technical Data*

Order no.	Stroke per jaw [°]	Gripping moment in closing max. [Nm]	Gripping force in closing max. [N]	Weight [kg]
GG1085NC	20	160	9600	2.8
GG1085FNC	20	160	9600	3.2



*All data measured at 6 bar

Gripping moment diagram

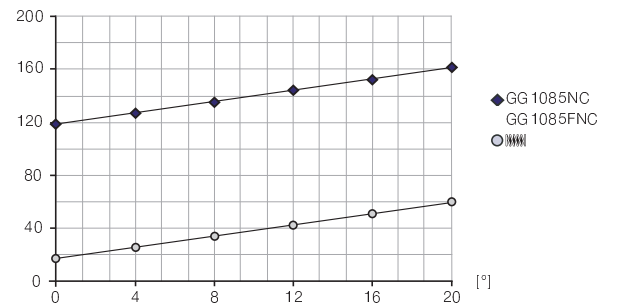
[Nm] Gripping force as a function of opening angle.

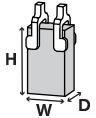
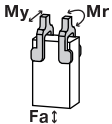

Installation Size: GG1110



	► Dimension			
	Width [mm]	Height [mm]	Depth [mm]	
	170	150	110	
	► Force and moment			
	Mr [Nm]	My [Nm]	Fa [N]	
	60	65	1000	
	► Technical Data*			
	Stroke per jaw	Gripping moment in closing max.	Gripping force in closing max.	Weight
	[°]	[Nm]	[N]	[kg]
	Order no.			
	GG1110NC	20	900	36000
GG1110FNC	20	450	23200	6.7

*All data measured at 6 bar

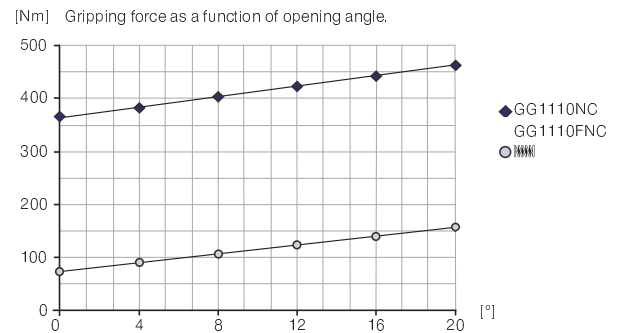
► Gripping moment diagram

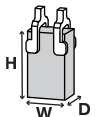
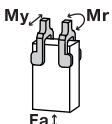

Installation Size: GG1140

	► Dimension			
	Width [mm]	Height [mm]	Depth [mm]	
	210	186.5	140	
	► Force and moment			
	Mr [Nm]	My [Nm]	Fa [N]	
	110	120	1500	
	► Technical Data*			
	Stroke per jaw	Gripping moment in closing max.	Gripping force in closing max.	Weight
	[°]	[Nm]	[N]	[kg]
	Order no.			
	GG1140NC	20	450	23200
GG1140FNC	20	900	36000	13

*All data measured at 6 bar

► Gripping moment diagram

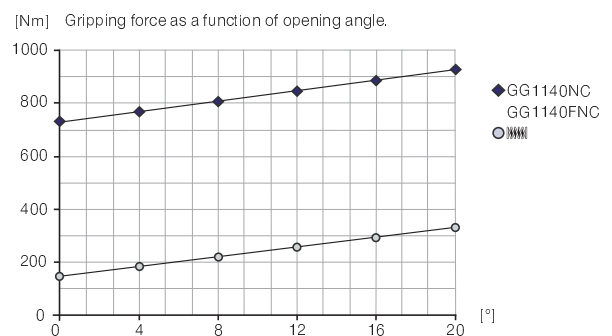

2-JAW ANGULAR GRIPPERS

SERIES GG1000

▶ ACCESSORIES

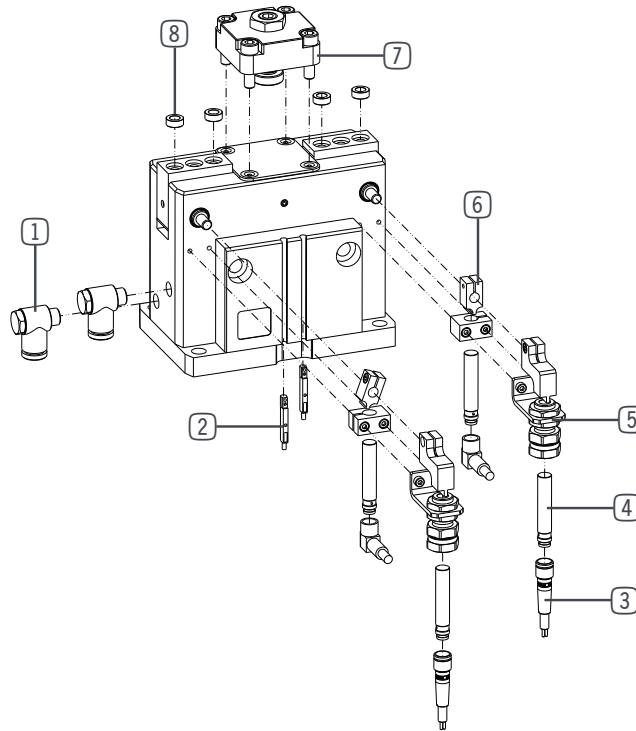

▶ Installation Size: GG1065

Pos.	Accessories	Order no.
①	Straight Fittings - Quick Connect Style	GVM5
②	Magnetic field sensor Angled Cable 5 m	MFS103KHC
②	Magnetic field sensor Angled Cable 0,3 m - Connector M8	MFS103SKHC
②	Magnetic field sensor Straight Cable 5 m	MFS204KHC
②	Magnetic field sensor Straight Cable 0,3 m - Connector M8	MFS204SKHC
③	Plug-in connector Straight Cable 5m - Socket M8 (female)	KAG500
③	Plug-in connector Angled Cable 5m - Socket M8 (female)	KAW500
④	Inductive proximity switch - Cable 5 m	NJ8-E2
④	Inductive proximity switch - Connector M8	NJ8-E2S
⑤	Alternate proximity bracket	KHA1065-8
⑥	Mounting block	KB8-43
⑦	Stroke adjustment screw	HES0009
	Quick Exhaust Valve	DEV04
	Pressure Safety Valve	DSV1-8
	Plug-in connector customizable Straight - Connector M8	S8-G-3
	Plug-in connector customizable Straight - Connector M12	S12-G-3
	Delivery contents	Order no.
⑧	Centering Disc	BDST40800

▶ Installation Size: GG1085

Pos.	Accessories	Order no.
①	Straight Fittings - Quick Connect Style	GV1-8X6
②	Magnetic field sensor Angled Cable 5 m	MFS103KHC
②	Magnetic field sensor Angled Cable 0,3 m - Connector M8	MFS103SKHC
②	Magnetic field sensor Straight Cable 5 m	MFS204KHC
②	Magnetic field sensor Straight Cable 0,3 m - Connector M8	MFS204SKHC
③	Plug-in connector Straight Cable 5m - Socket M8 (female)	KAG500
③	Plug-in connector Angled Cable 5m - Socket M8 (female)	KAW500
④	Inductive proximity switch - Cable 5 m	NJ8-E2
④	Inductive proximity switch - Connector M8	NJ8-E2S
⑤	Alternate proximity bracket	KHA1085-8
⑥	Mounting block	KB8-43
⑦	Stroke adjustment screw	HES0006
	Quick Exhaust Valve	DEV06
	Pressure Safety Valve	DSV1-8
	Plug-in connector customizable Straight - Connector M8	S8-G-3
	Plug-in connector customizable Straight - Connector M12	S12-G-3
	Delivery contents	Order no.
⑧	Centering Disc	BDST41000

► Installation Size: **GG1110**

Pos.	Accessories	Order no.
①	Straight Fittings - Quick Connect Style	GV1-8X6
②	Magnetic field sensor Angled Cable 5 m	MFS103KHC
②	Magnetic field sensor Angled Cable 0,3 m - Connector M8	MFS103SKHC
②	Magnetic field sensor Straight Cable 5 m	MFS204KHC
②	Magnetic field sensor Straight Cable 0,3 m - Connector M8	MFS204SKHC
③	Plug-in connector Straight Cable 5m - Socket M8 (female)	KAG500
③	Plug-in connector Angled Cable 5m - Socket M8 (female)	KAW500
④	Inductive proximity switch - Cable 5 m	NJ8-E2
④	Inductive proximity switch - Connector M8	NJ8-E2S
⑤	Alternate proximity bracket	KHA1110-8
⑥	Mounting block	KB8-43
⑦	Stroke adjustment screw	HES0007
	Quick Exhaust Valve	DEV06
	Pressure Safety Valve	DSV1-8
	Plug-in connector customizable Straight - Connector M8	S8-G-3
	Plug-in connector customizable Straight - Connector M12	S12-G-3
	Delivery contents	Order no.
⑧	Centering Disc	BDST41600

► Installation Size: **GG1140**

Pos.	Accessories	Order no.
①	Straight Fittings - Quick Connect Style	GV1-4X8
②	Magnetic field sensor Angled Cable 5 m	MFS103KHC
②	Magnetic field sensor Angled Cable 0,3 m - Connector M8	MFS103SKHC
②	Magnetic field sensor Straight Cable 5 m	MFS204KHC
②	Magnetic field sensor Straight Cable 0,3 m - Connector M8	MFS204SKHC
③	Plug-in connector Straight Cable 5m - Socket M8 (female)	KAG500
③	Plug-in connector Angled Cable 5m - Socket M8 (female)	KAW500
④	Inductive proximity switch - Cable 5 m	NJ8-E2
④	Inductive proximity switch - Connector M8	NJ8-E2S
⑤	Alternate proximity bracket	KHA1140-8
⑥	Mounting block	KB8-43
⑦	Stroke adjustment screw	HES0008
	Quick Exhaust Valve	DEV08
	Pressure Safety Valve	DSV1-8
	Plug-in connector customizable Straight - Connector M8	S8-G-3
	Plug-in connector customizable Straight - Connector M12	S12-G-3
	Delivery contents	Order no.
⑧	Centering Disc	BDST42000

2-JAW ANGULAR GRIPPERS

SERIES GG4000

▶ PRODUCT ADVANTAGES

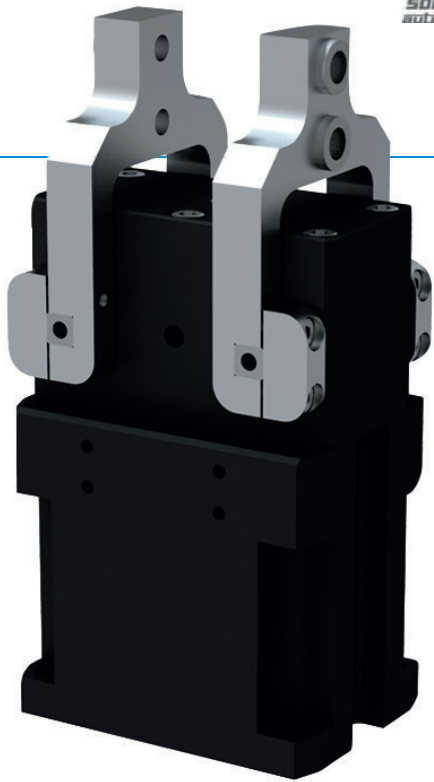

“The airtight”

▶ **Suitable for use under water**

The sealed rotation axis guarantees process reliability even under the harshest conditions

▶ **Smooth stroke configuration**

You can adjust the 180° opening angle to be unique to your application using an adjusting screw

▶ **Failure-free continuous operation**

Our uncompromising “Made in Germany” quality guarantees up to 10 million maintenance-free gripping cycles

▶ THE BEST PRODUCT FOR YOUR APPLICATION



▶ **Our products love the challenge!**

Extreme conditions, all over the world—our tried and tested components and systems give you limitless possibilities:

Find the best product for your specific use:

www.zimmer-group.de

► BENEFITS IN DETAIL

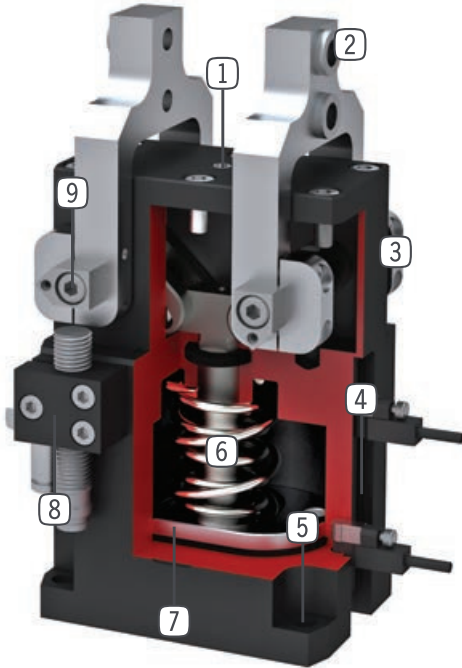

- ① **Stroke adjustment screw**
- Infinitely adjustable opening stroke
- ② **Removable centering sleeves**
- individual gripper finger mounting
- ③ **Robust, lightweight housing**
- hard coated aluminium alloy
- ④ **Sensing slot**
- mounting and positioning of magnetic field sensors
- ⑤ **Mounting and positioning**
- mounting possible from several sides for versatile positioning
- ⑥ **Integrated gripping force safety device**
- spring integrated into cylinder as energy storage
- ⑦ **Position sensing**
- permanent magnet for direct monitoring of piston movement
- ⑧ **Mounting block**
- mounting for inductive proximity switch
- ⑨ **Sealed rotation point**
- for use under extreme conditions

► FURTHER INFORMATION IS AVAILABLE ONLINE



► Technical Information

All information just a click away at: www.zimmer-group.de
Find data, illustrations, 3D models and Installation instructions for your installation size using the order number for your desired product.
Quick, clear and always current.



2-JAW ANGULAR GRIPPERS

SERIES GG4000

1

Series GG4000 / 2-Jaw Angular Grippers / pneumatic / Grippers

Installation Size: GG4030

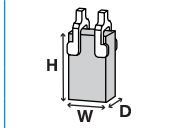

Dimension

Width [mm]	Height [mm]	Depth [mm]
44	87.5	32

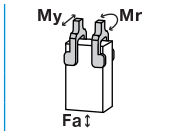

Force and moment

Mr [Nm]	My [Nm]	Fa [N]
8.5	8.5	180

Technical Data*

	Stroke per jaw [°]	Gripping moment in closing at 0° [Nm]	Weight [kg]
Order no.			
GG4032NC	90	6.5	0.25
GG4032SC	20	7	0.25

*All data measured at 6 bar

Gripping moment diagram

[Nm] Gripping force as a function of opening angle.

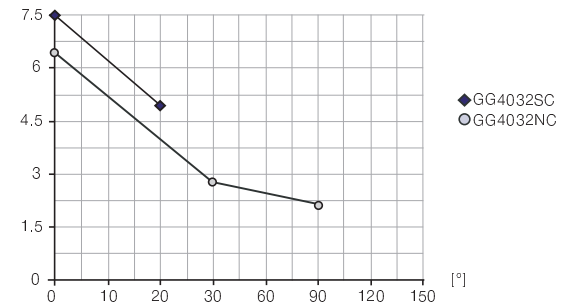

Installation Size: GG4040

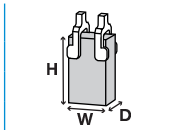

Dimension

Width [mm]	Height [mm]	Depth [mm]
55	114	40

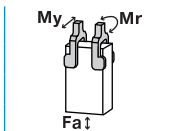

Force and moment

Mr [Nm]	My [Nm]	Fa [N]
19	19	180

Technical Data*

	Stroke per jaw [°]	Gripping moment in closing at 0° [Nm]	Weight [kg]
Order no.			
GG4040NC	90	13	0.5
GG4040SC	20	15	0.5

*All data measured at 6 bar

Gripping moment diagram

[Nm] Gripping force as a function of opening angle.

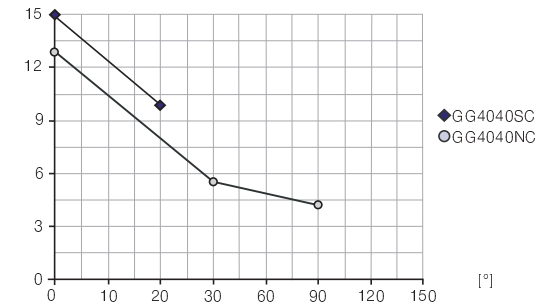

Installation Size: GG4049

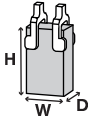

Dimension

Width [mm]	Height [mm]	Depth [mm]
66	134.5	48

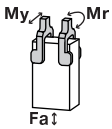

Force and moment

Mr [Nm]	My [Nm]	Fa [N]
22	22	475

Technical Data*

Order no.	Stroke per jaw [°]	Gripping moment in closing at 0° [Nm]	Weight [kg]
GG4049NC	90	23	0.85
GG4049SC	20	26	0.85

*All data measured at 6 bar

Gripping moment diagram

[Nm] Gripping force as a function of opening angle.

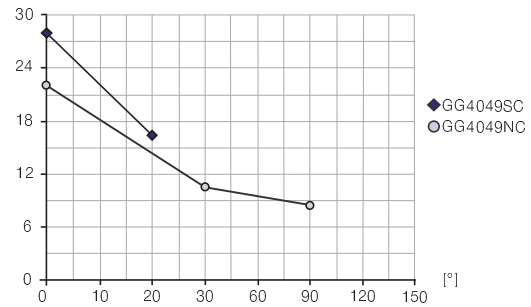

Installation Size: GG4058

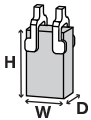

Dimension

Width [mm]	Height [mm]	Depth [mm]
79	154	58

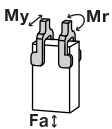

Force and moment

Mr [Nm]	My [Nm]	Fa [N]
33	33	720

Technical Data*

Order no.	Stroke per jaw [°]	Gripping moment in closing at 0° [Nm]	Weight [kg]
GG4058NC	90	46	1.4
GG4058SC	20	53.5	1.4

*All data measured at 6 bar

Gripping moment diagram

[Nm] Gripping force as a function of opening angle.

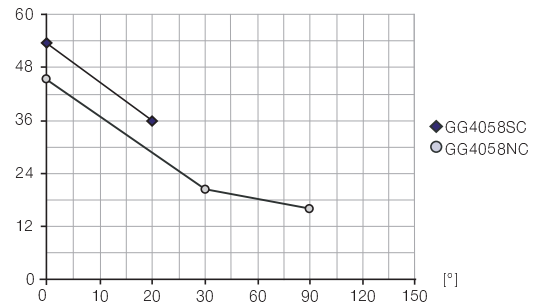

2-JAW ANGULAR GRIPPERS

SERIES GG4000

1

Series GG4000 / 2-Jaw Angular Grippers / pneumatic / Grippers

Installation Size: GG4072

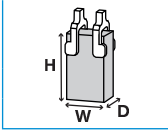

Dimension

Width [mm]	Height [mm]	Depth [mm]
95	183.5	72

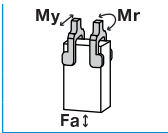

Force and moment

Mr [Nm]	My [Nm]	Fa [N]
41	41	1100

Technical Data*

Order no.	Stroke per jaw [°]	Gripping moment in closing at 0° [Nm]	Weight [kg]
GG4072NC	90	69	2.45
GG4072SC	20	94	2.45

*All data measured at 6 bar

Gripping moment diagram

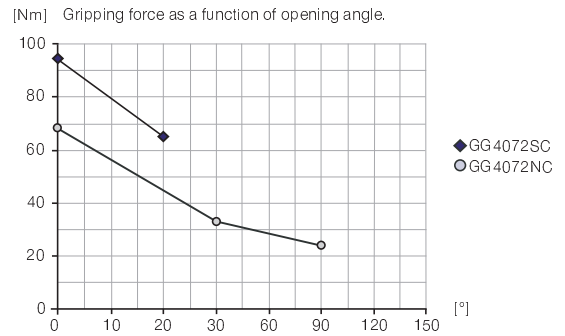

Installation Size: GG4084

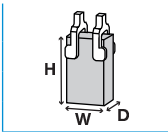

Dimension

Width [mm]	Height [mm]	Depth [mm]
114	236	84

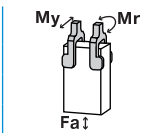

Force and moment

Mr [Nm]	My [Nm]	Fa [N]
60	60	1800

Technical Data*

Order no.	Stroke per jaw [°]	Gripping moment in closing at 0° [Nm]	Weight [kg]
GG4084NC	90	135	4.5
GG4084SC	20	156	4.5

*All data measured at 6 bar

Gripping moment diagram

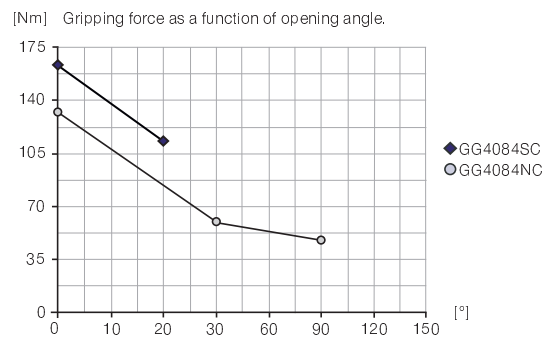

2-JAW ANGULAR GRIPPERS

SERIES GG4000

▶ ACCESSORIES

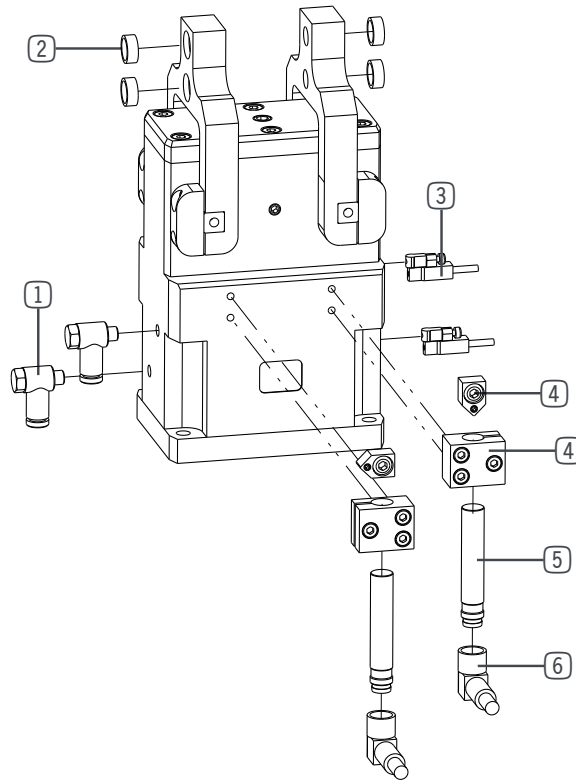

▶ Installation Size: GG4030

Pos.	Accessories	Order no.
①	Straight Fittings - Quick Connect Style	GVM5
③	Sensor-set	MFS103S-01
③	Sensor-set	MFS204S-01
③	2-Position-Sensor Cable 5m	MFSP2KHC
④	Mounting block	KB4-06
⑤	Inductive proximity switch - Cable 5 m	NJ4-E2
⑥	Plug-in connector Straight Cable 5m - Socket M8 (female)	KAG500
⑥	Plug-in connector Angled Cable 5m - Socket M8 (female)	KAW500
	Pressure Safety Valve	DSV1-8
	Plug-in connector customizable Straight - Connector M8	S8-G-3
	Plug-in connector customizable Straight - Connector M12	S12-G-3
	Delivery contents	Order no.
②	Centering Disc	BDST40600
	Stroke adjustment screw	HES0014

▶ Installation Size: GG4040

Pos.	Accessories	Order no.
①	Straight Fittings - Quick Connect Style	GVM5
③	Sensor-set	MFS103S-01
③	Sensor-set	MFS204S-01
③	2-Position-Sensor Cable 5m	MFSP2KHC
④	Mounting block	KB8-48
⑤	Inductive proximity switch - Connector M8	NJ8-E2S
⑥	Plug-in connector Straight Cable 5m - Socket M8 (female)	KAG500
⑥	Plug-in connector Angled Cable 5m - Socket M8 (female)	KAW500
	Pressure Safety Valve	DSV1-8
	Plug-in connector customizable Straight - Connector M8	S8-G-3
	Plug-in connector customizable Straight - Connector M12	S12-G-3
	Delivery contents	Order no.
②	Centering Disc	BDST40800
	Stroke adjustment screw	HES0015

► Installation Size: GG4049

Pos.	Accessories	Order no.
①	Straight Fittings - Quick Connect Style	GVM5
③	Sensor-set	MFS103S-01
③	Sensor-set	MFS204S-01
③	2-Position-Sensor Cable 5m	MFSP2KHC
④	Mounting block	KB8-49
⑤	Inductive proximity switch - Connector M8	NJ8-E2S
⑥	Plug-in connector Straight Cable 5m - Socket M8 (female)	KAG500
⑥	Plug-in connector Angled Cable 5m - Socket M8 (female)	KAW500
	Pressure Safety Valve	DSV1-8
	Plug-in connector customizable Straight - Connector M8	S8-G-3
	Plug-in connector customizable Straight - Connector M12	S12-G-3
	Delivery contents	Order no.
②	Centering Disc	BDST41000
	Stroke adjustment screw	HES0016

► Installation Size: GG4072

Pos.	Accessories	Order no.
①	Straight Fittings - Quick Connect Style	GV1-8X6
③	Sensor-set	MFS103S-01
③	Sensor-set	MFS204S-01
③	2-Position-Sensor Cable 5m	MFSP2KHC
④	Mounting block	KB8-49
⑤	Inductive proximity switch - Connector M8	NJ8-E2S
⑥	Plug-in connector Straight Cable 5m - Socket M8 (female)	KAG500
⑥	Plug-in connector Angled Cable 5m - Socket M8 (female)	KAW500
	Pressure Safety Valve	DSV1-8
	Plug-in connector customizable Straight - Connector M8	S8-G-3
	Plug-in connector customizable Straight - Connector M12	S12-G-3
	Delivery contents	Order no.
②	Centering Disc	BDST42000
	Stroke adjustment screw	HES0018

► Installation Size: GG4058

Pos.	Accessories	Order no.
①	Straight Fittings - Quick Connect Style	GVM5
③	Sensor-set	MFS103S-01
③	Sensor-set	MFS204S-01
③	2-Position-Sensor Cable 5m	MFSP2KHC
④	Mounting block	KB8-49
⑤	Inductive proximity switch - Connector M8	NJ8-E2S
⑥	Plug-in connector Straight Cable 5m - Socket M8 (female)	KAG500
⑥	Plug-in connector Angled Cable 5m - Socket M8 (female)	KAW500
	Pressure Safety Valve	DSV1-8
	Plug-in connector customizable Straight - Connector M8	S8-G-3
	Plug-in connector customizable Straight - Connector M12	S12-G-3
	Delivery contents	Order no.
②	Centering Disc	BDST11500
	Stroke adjustment screw	HES0017

► Installation Size: GG4084

Pos.	Accessories	Order no.
①	Straight Fittings - Quick Connect Style	GV1-8X6
③	Sensor-set	MFS103S-01
③	Sensor-set	MFS204S-01
③	2-Position-Sensor Cable 5m	MFSP2KHC
④	Mounting block	KB8-49
⑤	Inductive proximity switch - Connector M8	NJ8-E2S
⑥	Plug-in connector Straight Cable 5m - Socket M8 (female)	KAG500
⑥	Plug-in connector Angled Cable 5m - Socket M8 (female)	KAW500
	Pressure Safety Valve	DSV1-8
	Plug-in connector customizable Straight - Connector M8	S8-G-3
	Plug-in connector customizable Straight - Connector M12	S12-G-3
	Delivery contents	Order no.
②	Centering Disc	BDST43000
	Stroke adjustment screw	HES0019

2-JAW ANGULAR GRIPPERS SERIES GK

▶ PRODUCT ADVANTAGES

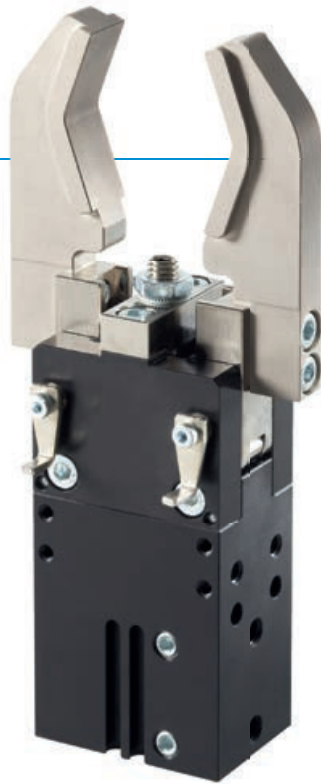

SOMMER
automatic **S**

“The compact”

▶ Proven technology

We have more than 20 years of proven reliability, which ensures uninterrupted production for you

▶ Best force/installation space ratio

Force transmission using the toggle lever enables high gripping force while optimally utilising the installation space

▶ Smooth stroke configuration

You can adjust the 180° opening angle to be unique to your application using an adjusting screw

▶ THE BEST PRODUCT FOR YOUR APPLICATION

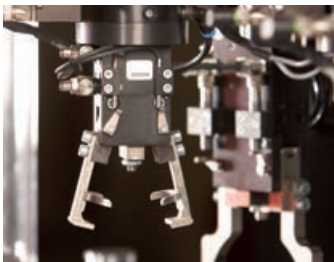

▶ Our products love the challenge!

Extreme conditions, all over the world—our tried and tested components and systems give you limitless possibilities:

Find the best product for your specific use:

www.zimmer-group.de

► BENEFITS IN DETAIL

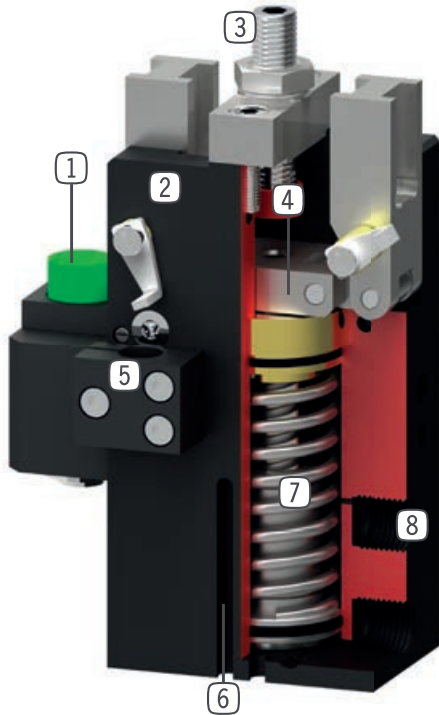

- ① **Buffer stop**
 - absorption of kinetic energy for heavy and long gripper fingers
- ② **Robust, lightweight housing**
 - hard coated aluminium alloy
- ③ **Stroke adjustment screw**
 - Infinitely adjustable opening stroke
- ④ **Wedge hook mechanism**
 - synchronized the movement of the gripper jaws
 - mechanically self-locking
- ⑤ **Mounting block**
 - mounting for inductive proximity switch
- ⑥ **Sensing slot**
 - mounting and positioning of magnetic field sensors
- ⑦ **Integrated gripping force safety device**
 - spring integrated into cylinder as energy storage
- ⑧ **Energy supply**
 - possible from several sides

► FURTHER INFORMATION IS AVAILABLE ONLINE



► Technical Information

All information just a click away at: www.zimmer-group.de

Find data, illustrations, 3D models and Installation instructions for your installation size using the order number for your desired product.

Quick, clear and always current.



2-JAW ANGULAR GRIPPERS SERIES GK

1

Series GK / 2-Jaw Angular Grippers / pneumatic / Grippers

Installation Size: GK15

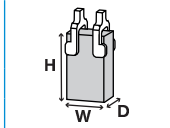

Dimension

Width [mm]	Height* [mm]	Depth [mm]
28	64.7	19.8

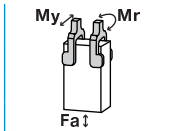

Force and moment

Mr [Nm]	My [Nm]	Fa [N]
0.4	0.4	75

Technical Data*

Order no.	Stroke per jaw [°]	Gripping moment in closing [Nm]	Gripping force in closing [N]	Weight [kg]
GK15N-B	90	1.2	70	0.1
GK15NC-B	90	1.6	100	0.12

*All data measured at 6 bar

** Version with gripping force protection (NC)

Gripping moment diagram

[Nm] Gripping force as a function of opening angle.

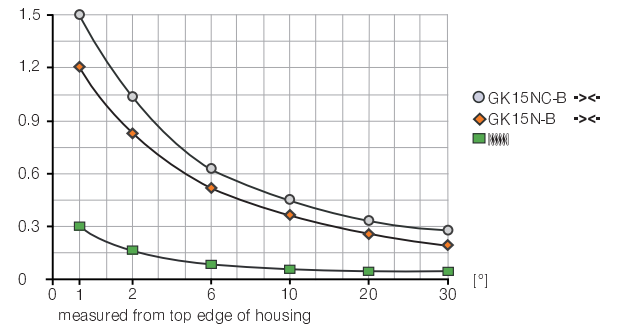

Installation Size: GK20

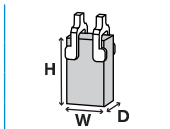

Dimension

Width [mm]	Height* [mm]	Depth [mm]
39	86.9	28

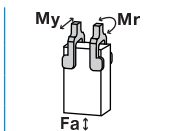

Force and moment

Mr [Nm]	My [Nm]	Fa [N]
0.8	1	150

Technical Data*

Order no.	Stroke per jaw [°]	Gripping moment in closing [Nm]	Gripping force in closing [N]	Weight [kg]
GK20N-B	90	3	150	0.23
GK20NC-B	90	4.2	210	0.3

*All data measured at 6 bar

** Version with gripping force protection (NC)

Gripping moment diagram

[Nm] Gripping force as a function of opening angle.

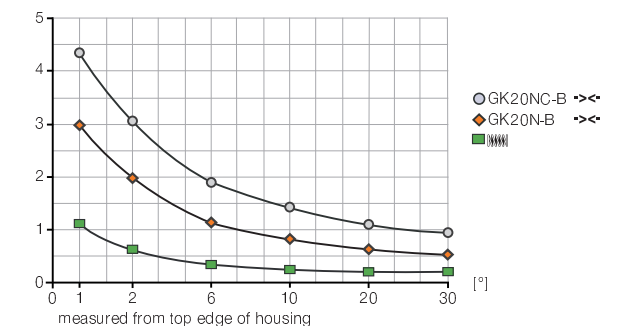

Installation Size: GK25

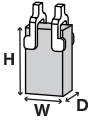

Dimension

Width [mm]	Height** [mm]	Depth [mm]
50	105.4	34.4

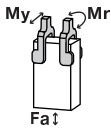

Force and moment

Mr [Nm]	My [Nm]	Fa [N]
2.5	4	250

Technical Data*

Order no.	Stroke per jaw [°]	Gripping moment in closing [Nm]	Gripping force in closing [N]	Weight [kg]
GK25N-B	90	10.5	440	0.42
GK25NC-B	90	14.5	610	0.58

*All data measured at 6 bar

**Version with gripping force protection (NC)

Gripping moment diagram

[Nm] Gripping force as a function of opening angle.

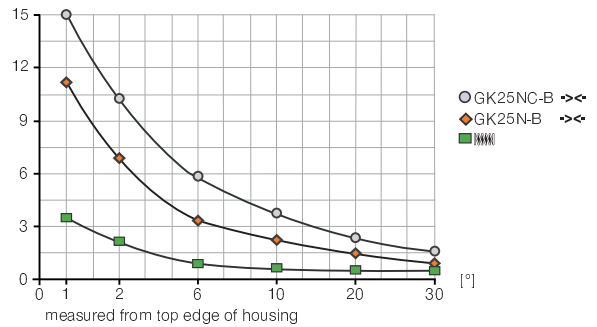

Installation Size: GK35

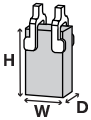

Dimension

Width [mm]	Height** [mm]	Depth [mm]
65	144.5	39.4

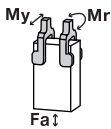

Force and moment

Mr [Nm]	My [Nm]	Fa [N]
12	20	400

Technical Data*

Order no.	Stroke per jaw [°]	Gripping moment in closing [Nm]	Gripping force in closing [N]	Weight [kg]
GK35N-B	90	27.5	950	0.9
GK35NC-B	90	36.5	1250	1.2

*All data measured at 6 bar

**Version with gripping force protection (NC)

Gripping moment diagram

[Nm] Gripping force as a function of opening angle.

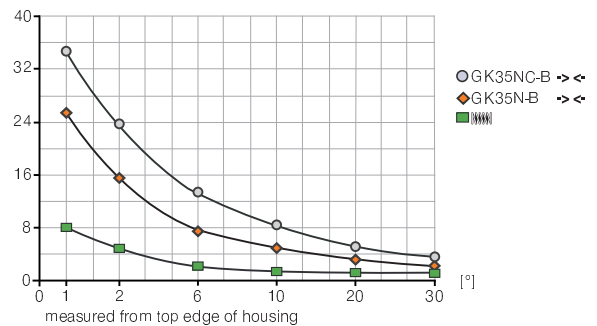

2-JAW ANGULAR GRIPPERS SERIES GK

1

Series GK / 2-Jaw Angular Grippers / pneumatic / Grippers

Installation Size: GK40

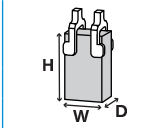

Dimension

Width [mm]	Height* [mm]	Depth [mm]
79	172	49.4

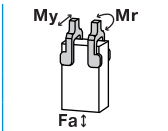

Force and moment

Mr [Nm]	My [Nm]	Fa [N]
17	30	600

Technical Data*

Order no.	Stroke per jaw [°]	Gripping moment in closing [Nm]	Gripping force in closing [N]	Weight [kg]
GK40N-B	90	47	1400	1.7
GK40NC-B	90	62	1820	2.2

*All data measured at 6 bar

**Version with gripping force protection (NC)

Gripping moment diagram

[Nm] Gripping force as a function of opening angle.

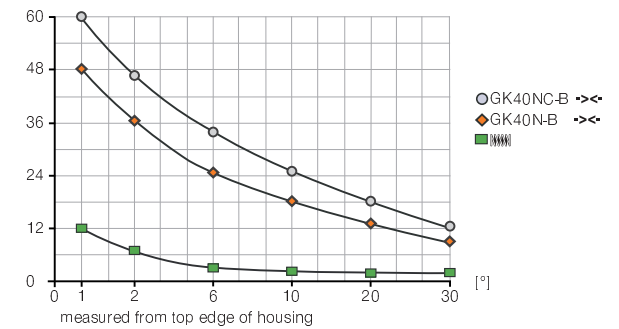

Installation Size: GK50

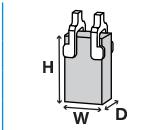

Dimension

Width [mm]	Height* [mm]	Depth [mm]
100	214	64

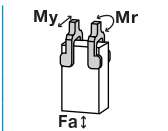

Force and moment

Mr [Nm]	My [Nm]	Fa [N]
28	40	800

Technical Data*

Order no.	Stroke per jaw [°]	Gripping moment in closing [Nm]	Gripping force in closing [N]	Weight [kg]
GK50N-B	90	150	3500	3.5
GK50NC-B	90	183	4250	4.1

*All data measured at 6 bar

**Version with gripping force protection (NC)

Gripping moment diagram

[Nm] Gripping force as a function of opening angle.

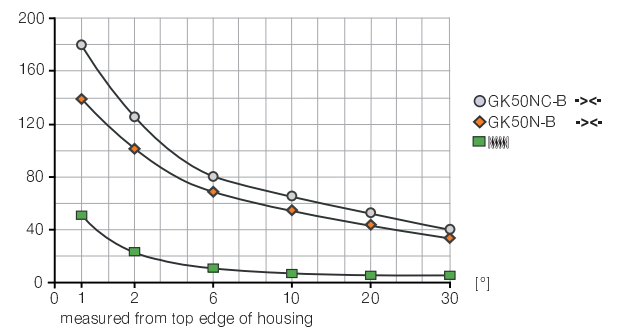

2-JAW ANGULAR GRIPPERS

SERIES GK

▶ ACCESSORIES

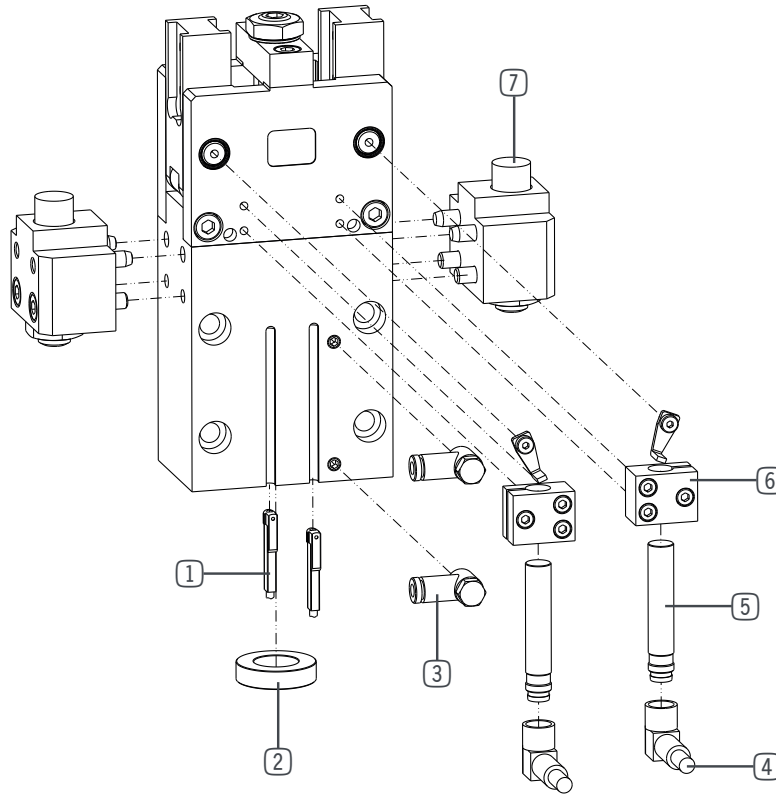

▶ Installation Size: GK15

Pos.	Accessories	Order no.
①	Magnetic field sensor Angled Cable 5 m	MFS103KHC
①	Magnetic field sensor Angled Cable 0,3 m - Connector M8	MFS103SKHC
②	Centering Disc	ZE12H7X4
③	Flow Control Valves - with Swivel joint	DRVM5X4
③	Straight Fittings - Quick Connect Style	GVM5
④	Plug-in connector Straight Cable 5m - Socket M8 (female)	KAG500
④	Plug-in connector Angled Cable 5m - Socket M8 (female)	KAW500
⑤	Inductive proximity switch - Cable 5 m	NJ3-E2
⑤	Inductive Proximity Switch Cable 0,3 m - Connector M8	NJ3-E2SK
⑥	Mounting block	KB3
⑦	Buffer stop	PB15N
	Plug-in connector customizable Straight - Connector M8	S8-G-3
	Plug-in connector customizable Straight - Connector M12	S12-G-3

▶ Installation Size: GK20

Pos.	Accessories	Order no.
①	Magnetic field sensor Angled Cable 5 m	MFS103KHC
①	Magnetic field sensor Angled Cable 0,3 m - Connector M8	MFS103SKHC
①	Magnetic field sensor Straight Cable 5 m	MFS204KHC
①	Magnetic field sensor Straight Cable 0,3 m - Connector M8	MFS204SKHC
②	Centering Disc	ZE20H7X4
③	Flow Control Valves - with Swivel joint	DRVM5X4
③	Straight Fittings - Quick Connect Style	GVM5
④	Plug-in connector Straight Cable 5m - Socket M8 (female)	KAG500
④	Plug-in connector Angled Cable 5m - Socket M8 (female)	KAW500
⑤	Inductive proximity switch - Cable 5 m	NJ8-E2
⑤	Inductive proximity switch - Connector M8	NJ8-E2S
⑦	Buffer stop	PB20N
	Plug-in connector customizable Straight - Connector M8	S8-G-3
	Plug-in connector customizable Straight - Connector M12	S12-G-3
	Delivery contents	Order no.
⑥	Mounting block	KB8K

► Installation Size: **GK25**

Pos.	Accessories	Order no.
①	Magnetic field sensor Angled Cable 5 m	MFS103KHC
①	Magnetic field sensor Angled Cable 0,3 m - Connector M8	MFS103SKHC
①	Magnetic field sensor Straight Cable 5 m	MFS204KHC
①	Magnetic field sensor Straight Cable 0,3 m - Connector M8	MFS204SKHC
②	Centering Disc	ZE20H7X4
③	Flow Control Valves - with Swivel joint	DRVM5X4
③	Straight Fittings - Quick Connect Style	GVM5
④	Plug-in connector Straight Cable 5m - Socket M8 (female)	KAG500
④	Plug-in connector Angled Cable 5m - Socket M8 (female)	KAW500
⑤	Inductive proximity switch - Cable 5 m	NJ8-E2
⑤	Inductive proximity switch - Connector M8	NJ8-E2S
⑦	Buffer stop	PB25N
	Plug-in connector customizable Straight - Connector M8	S8-G-3
	Plug-in connector customizable Straight - Connector M12	S12-G-3
	Delivery contents	Order no.
⑥	Mounting block	KB8K

► Installation Size: **GK40**

Pos.	Accessories	Order no.
①	Magnetic field sensor Angled Cable 5 m	MFS103KHC
①	Magnetic field sensor Angled Cable 0,3 m - Connector M8	MFS103SKHC
①	Magnetic field sensor Straight Cable 5 m	MFS204KHC
①	Magnetic field sensor Straight Cable 0,3 m - Connector M8	MFS204SKHC
②	Centering Disc	ZE30H7X4
③	Flow Control Valves - with Swivel joint	DRVM5X4
③	Straight Fittings - Quick Connect Style	GVM5
④	Plug-in connector Straight Cable 5m - Socket M8 (female)	KAG500
④	Plug-in connector Angled Cable 5m - Socket M8 (female)	KAW500
⑤	Inductive proximity switch - Cable 5 m	NJ8-E2
⑤	Inductive proximity switch - Connector M8	NJ8-E2S
⑦	Buffer stop	PB40N
	Plug-in connector customizable Straight - Connector M8	S8-G-3
	Plug-in connector customizable Straight - Connector M12	S12-G-3
	Delivery contents	Order no.
⑥	Mounting block	KB8K

► Installation Size: **GK35**

Pos.	Accessories	Order no.
①	Magnetic field sensor Angled Cable 5 m	MFS103KHC
①	Magnetic field sensor Angled Cable 0,3 m - Connector M8	MFS103SKHC
①	Magnetic field sensor Straight Cable 5 m	MFS204KHC
①	Magnetic field sensor Straight Cable 0,3 m - Connector M8	MFS204SKHC
②	Centering Disc	ZE25H7X6
③	Flow Control Valves - with Swivel joint	DRVM5X4
③	Straight Fittings - Quick Connect Style	GVM5
④	Plug-in connector Straight Cable 5m - Socket M8 (female)	KAG500
④	Plug-in connector Angled Cable 5m - Socket M8 (female)	KAW500
⑤	Inductive proximity switch - Cable 5 m	NJ8-E2
⑤	Inductive proximity switch - Connector M8	NJ8-E2S
⑦	Buffer stop	PB35N
	Plug-in connector customizable Straight - Connector M8	S8-G-3
	Plug-in connector customizable Straight - Connector M12	S12-G-3
	Delivery contents	Order no.
⑥	Mounting block	KB8K

► Installation Size: **GK50**

Pos.	Accessories	Order no.
①	Magnetic field sensor Angled Cable 5 m	MFS103KHC
①	Magnetic field sensor Angled Cable 0,3 m - Connector M8	MFS103SKHC
①	Magnetic field sensor Straight Cable 5 m	MFS204KHC
①	Magnetic field sensor Straight Cable 0,3 m - Connector M8	MFS204SKHC
②	Centering Disc	ZE30H7X6
③	Flow Control Valves - with Swivel joint	DRV1-8X6
③	Straight Fittings - Quick Connect Style	GV1-8X6
④	Plug-in connector Straight Cable 5m - Socket M8 (female)	KAG500
④	Plug-in connector Angled Cable 5m - Socket M8 (female)	KAW500
⑤	Inductive proximity switch - Cable 5 m	NJ8-E2
⑤	Inductive proximity switch - Connector M8	NJ8-E2S
	Plug-in connector customizable Straight - Connector M8	S8-G-3
	Plug-in connector customizable Straight - Connector M12	S12-G-3
	Delivery contents	Order no.
⑥	Mounting block	KB8K